

Accessories Catalogue

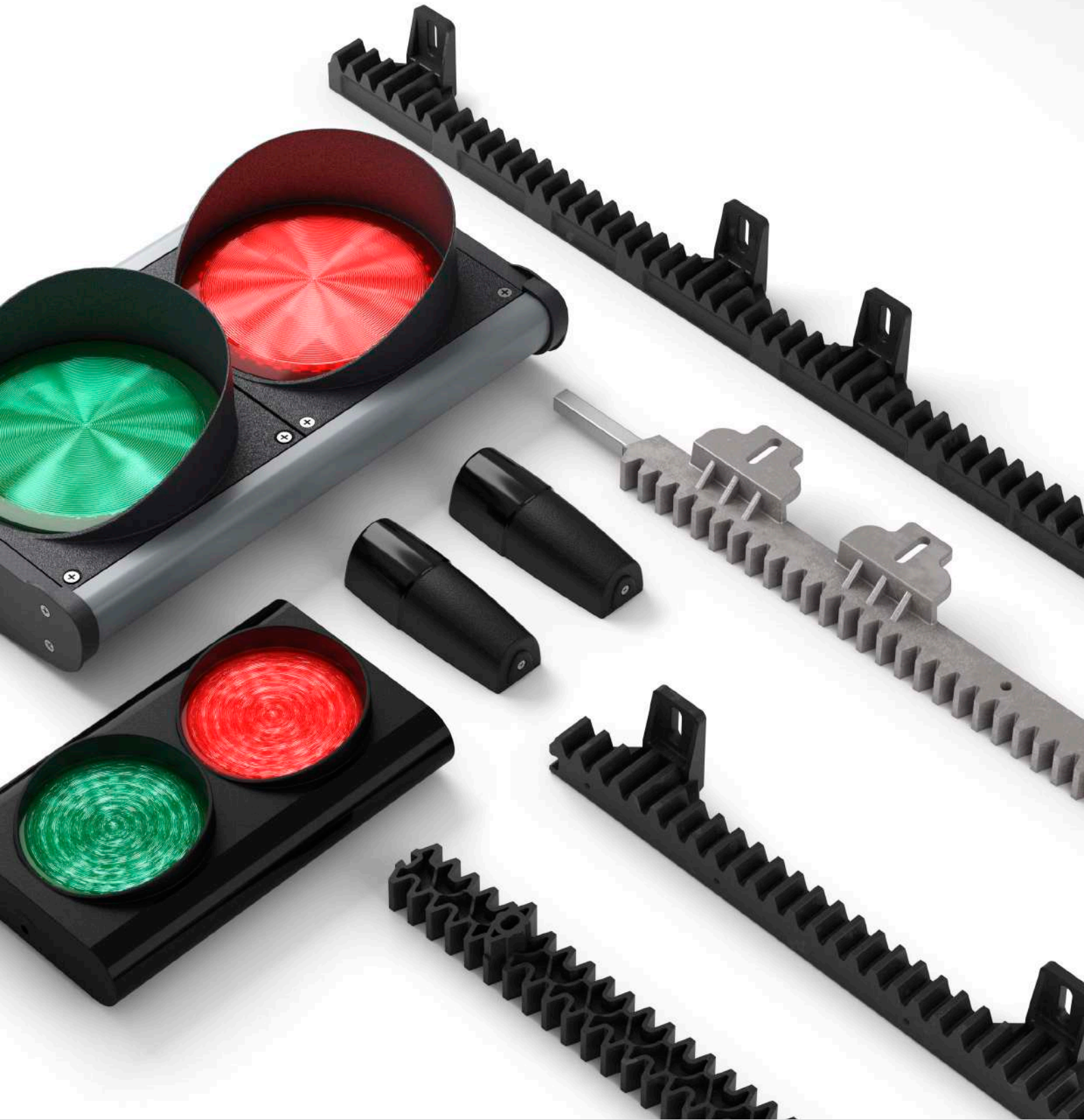

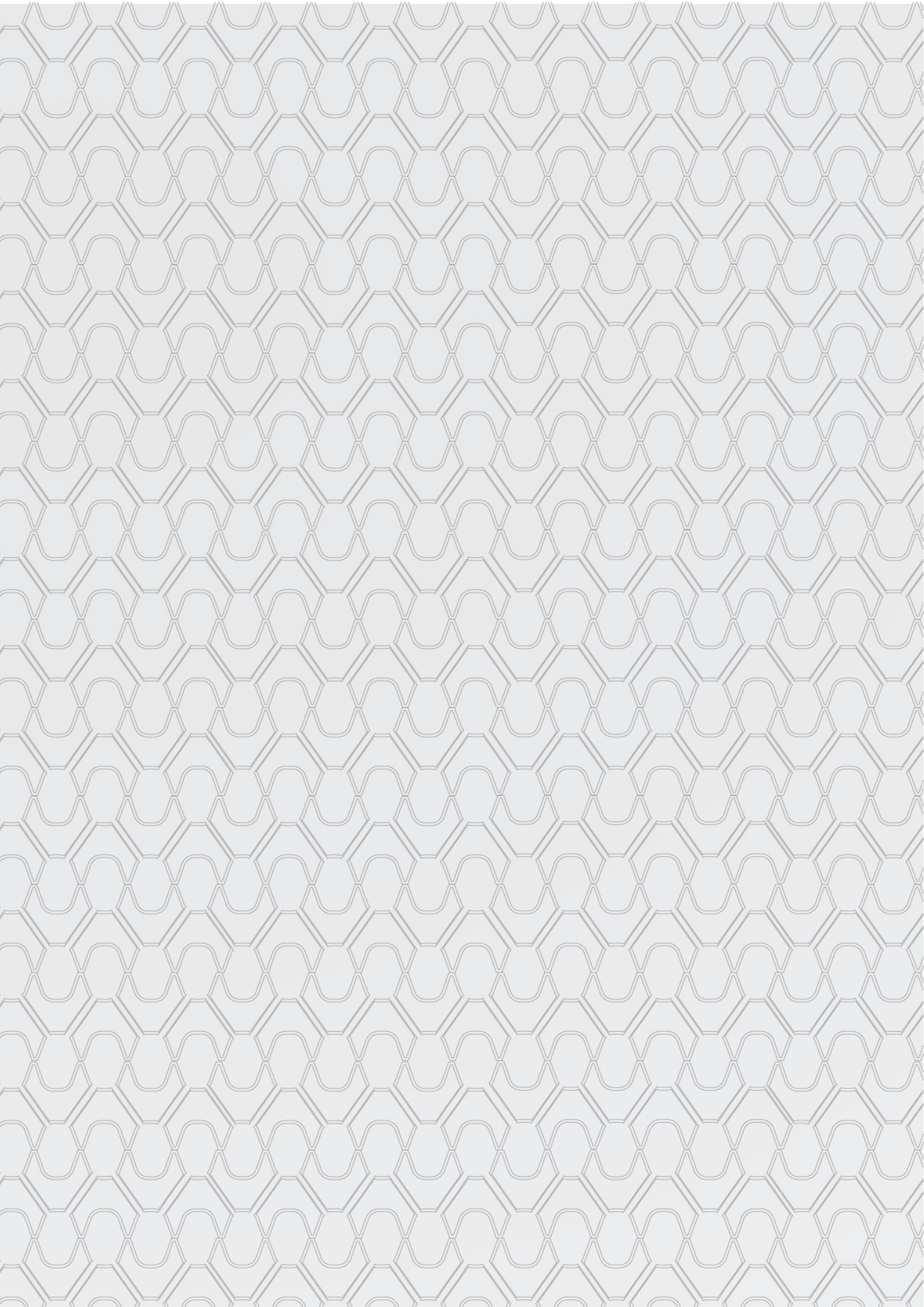

A STORY LASTING FOR MORE THAN 40 YEARS

- Ever since the year 1980, our company has been designing and creating products according to the initial idea of founder Francesco Albiero.
 - Starting with only a few presses and production on behalf of third parties, our company was always looking to grow and create value.
 - In order to achieve this, a long process made of investments, plenty of brainstorming and care for market requests was undertaken.
 - It was out of one of such moments that the first “Stagnoli” nylon rack was born, patented and still acknowledged today all over the world as a synonym of quality
 - Since its foundation the company **produces in Italy**, precisely in Lonato del Garda, and is active on both Italian and foreign markets.
 - There are more and more countries each year in which the firm **exports** its own brand of “made in Italy”
 - Over time, the company’s technical-productive know-how has grown significantly. Along with the technopolymers molding line, starting from the 90s a line of **products for automation and signaling** was launched, characterized by functionality, design and quality.
 - Today, Stagnoli offers a range of useful products for the **automation and signaling of mechanism of our everyday lives.**
-

“Remember, great ideas can arise even just from the observation of simple things”

Albiero Francesco

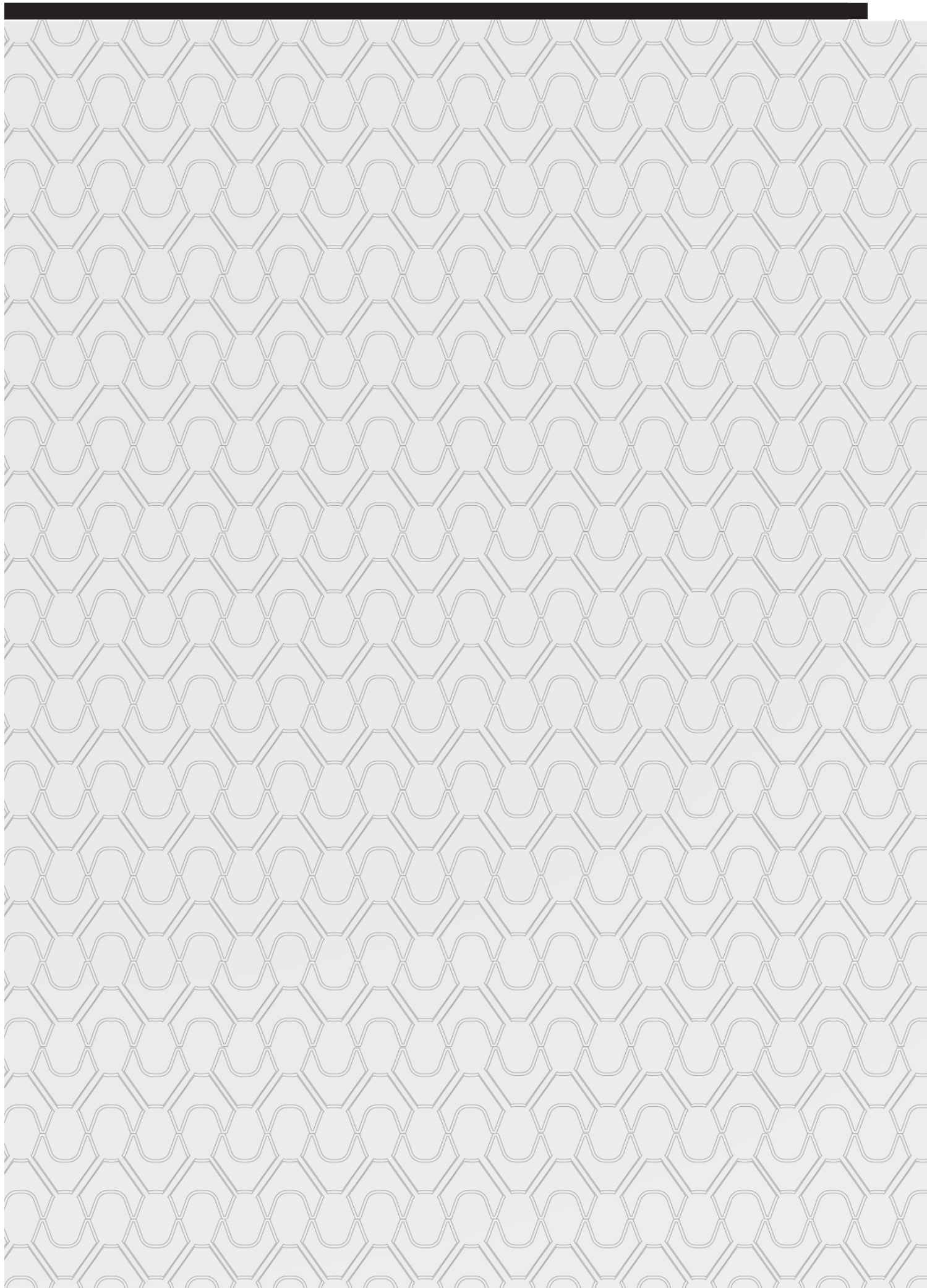

INDEX



SIGNALING ACCESSORIES

07

ERA80 TRAFFIC LIGHT	08
ERA801L TRAFFIC LIGHT	12
ERA80 TRAFFIC LIGHT - YELLOW	14
ERA801L TRAFFIC LIGHT - YELLOW	16
CHRONOS TRAFFIC LIGHT	18
APOLLO TRAFFIC LIGHT ALLUMINUM	22
APOLLO PLAST TRAFFIC LIGHT	26
APOLLO PLAST TRAFFIC LIGHT - YELLOW	30
DOCK LAMPS	34
PEGASUS FLASHING LIGHT	38
SATURNO CONTROL UNIT	40
ACNSEM3L CONTROL UNIT	42



RACKS

45

NYLON	46
STEEL	60



CONTROL ACCESSORIES

64

SAFETY ACCESSORIES

65

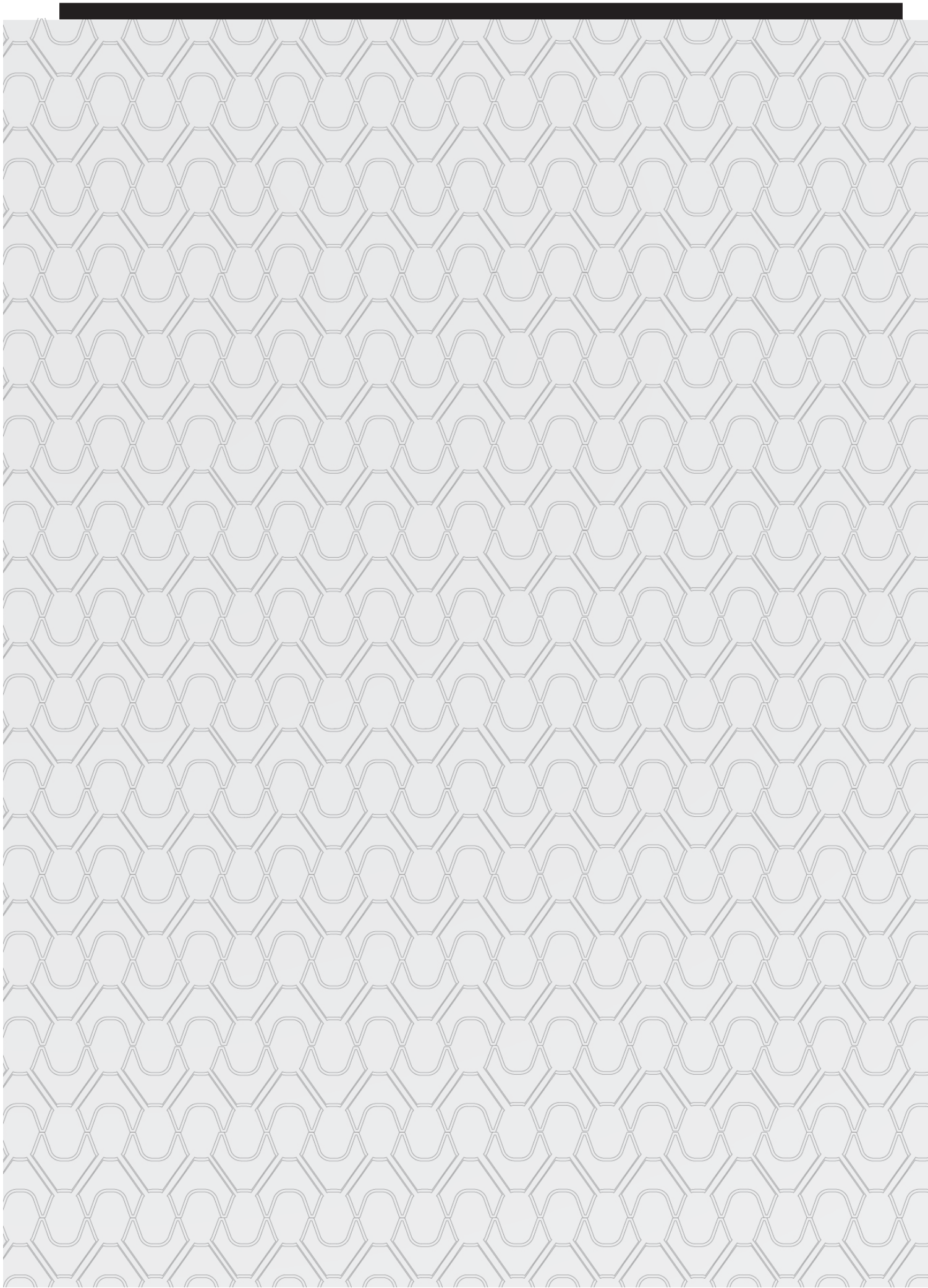



SIGNALING ACCESSORIES

07

ERA80 TRAFFIC LIGHT	08
ERA801L TRAFFIC LIGHT	12
ERA80 TRAFFIC LIGHT - YELLOW	14
ERA801L TRAFFIC LIGHT - YELLOW	16
CHRONOS TRAFFIC LIGHT	18
APOLLO TRAFFIC LIGHT ALLUMINUM	22
APOLLO PLAST TRAFFIC LIGHT	26
APOLLO PLAST TRAFFIC LIGHT - YELLOW	30
DOCK LAMPS	34
PEGASUS FLASHING LIGHT	38
SATURNO CONTROL UNIT	40
ACNSEM3L CONTROL UNIT	42

ERA80



— MADE IN ITALY —

A SUSTAINABLE ALLY

Our commitment towards the creation of sustainable products also includes the use of recycled materials in our production.

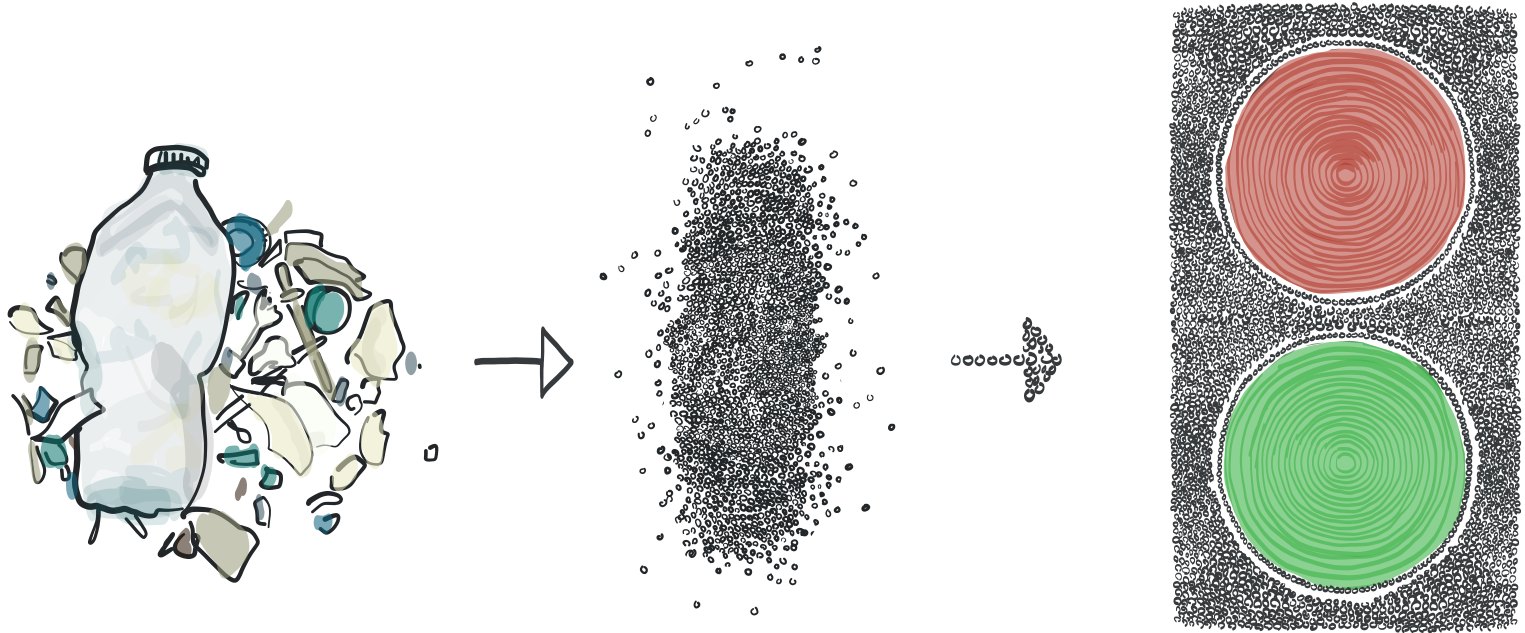

ERA 80 is a traffic light in post-consumer recycled plastic, the first of its kind in the world. Developed according to all principles of sustainable development: a lantern made in polyamide produced from industrial waste.

This traffic light is designed to meet high safety standards, with an attractive yet simple design.

It is a signaling product suitable for different contexts:

pedestrian crossings, parking lots, entrances in residential contexts.

ERA80 is not only a "design" product, but is most importantly a sustainable product, for meeting to the needs of a market getting increasingly sensitive to the issue of safety.

Product details

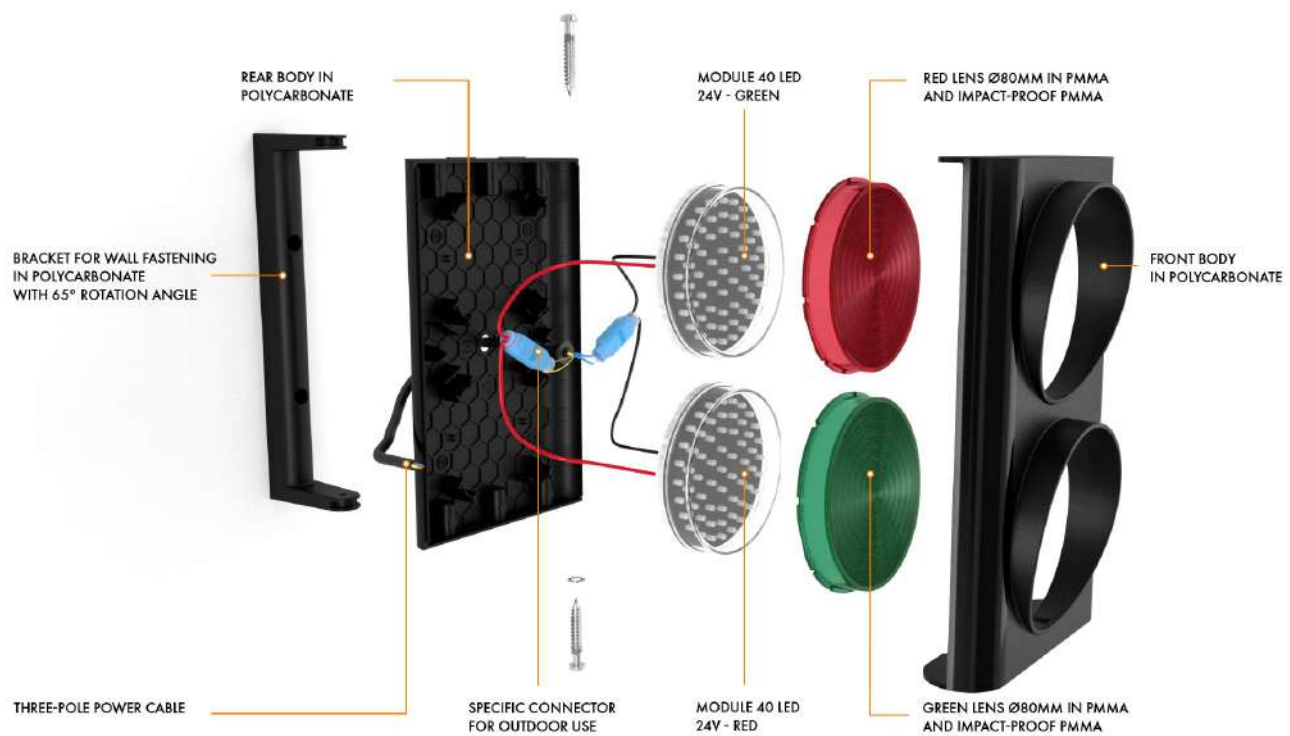

Models

VERTICAL



HORIZONTAL



Easy to install

ERA80 makes the installation process simple thanks to its new fixing systems, with bracket and wall fixing

VERTICAL WITH BRACKET



HORIZONTAL WITH BRACKET



VERTICAL WITHOUT BRACKET



HORIZONTAL WITHOUT BRACKET



APPLICATION WITH POLE BRACKET



Technical details

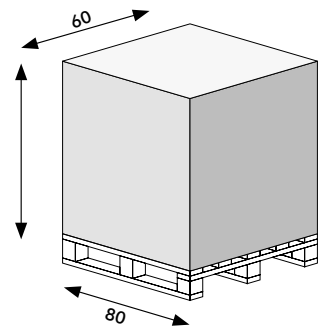

H120cm - pcs.48



TECHNICAL DATA	ASFERA80 Traffic light set, 2 lights	ASFERA80D Directional vertical traffic light, 2 lights	ASFERA80O Horizontal traffic light, 2 lights	ASFERA80OD Directional horizontal traffic light, 2 lights
Power supply	24V	24V	24V	24V
Rated absorbed current	0,13A	0,13A	0,13A	0,13A
Power	1,50W	1,50W	1,50W	1,50W
Brightness	120lx (±10lx)	120lx (±10lx)	120lx (±10lx)	120lx (±10lx)
Working temperature	-20/+55°	-20/+55°	-20/+55°	-20/+55°
IP	66	66	66	66
Number of LEDs	40	40	40	40

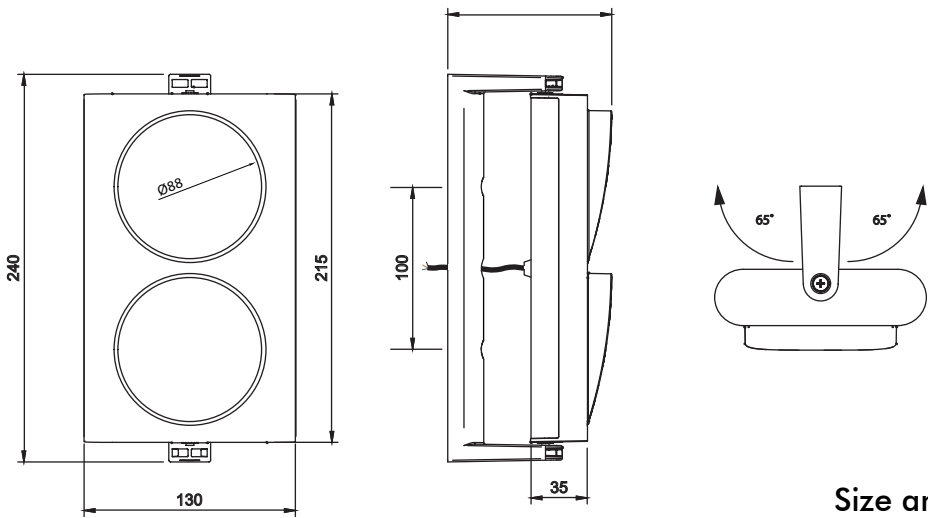

Size and bulk

Accessories



ASFERA80SP

Brackets for pole mounting

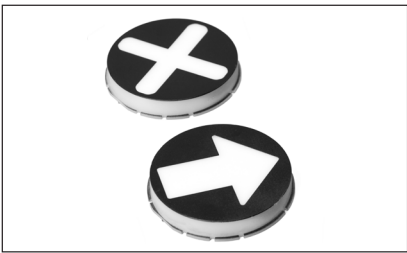

ASFERA80LD

Directional lenses kit



APS

Galvanized pole (Ø60mm)

ERA801L



EXTERNAL USE



EASY TO INSTALL

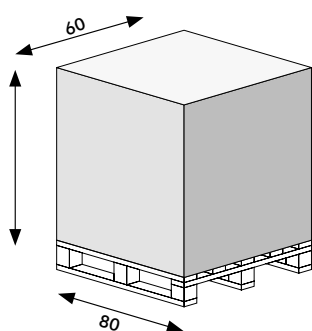

H120cm -
pcs.96



TECHNICAL DATA	ASFERA801LR	ASFERA801LV	ASFERA801LG
Power supply	24V	24V	24V
Rated absorbed current	0,13A	0,13A	0,13A
Power	1,50W	1,50W	1,50W
Brightness	120lx (+10lx)	120lx (+10lx)	120lx (+10lx)
Working temperature	-20/+55°	-20/+55°	-20/+55°
IP	66	66	66
Number of LEDs	40	40	40

VERTICAL WITH
BRACKET

VERTICAL WITHOUT
BRACKET

APPLICATION WITH POLE
BRACKET



ASFERA801LRV TWINCOLOR

Double coloring (red-green)
in one body with 40 LEDs (20 + 20) integrated.

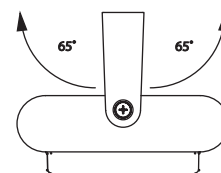
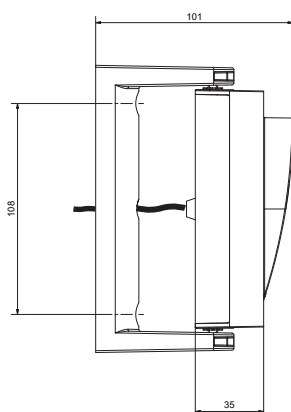
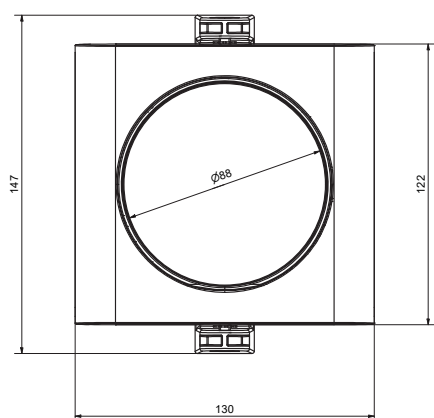
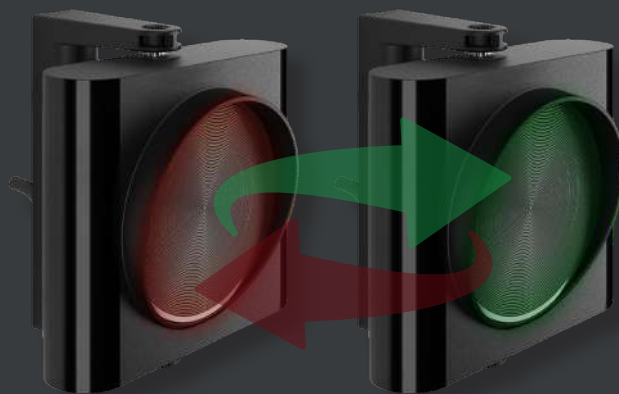

Size and bulk

Accessories



ASFERA80SP

Brackets for pole mounting

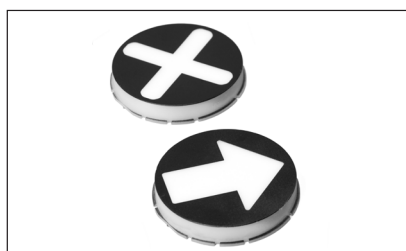

ASFERA80LD

Directional lenses kit



APS

Galvanized pole (Ø60mm)

ERA80

YELLOW

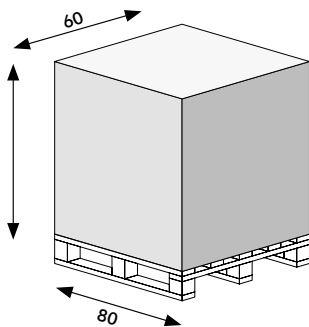
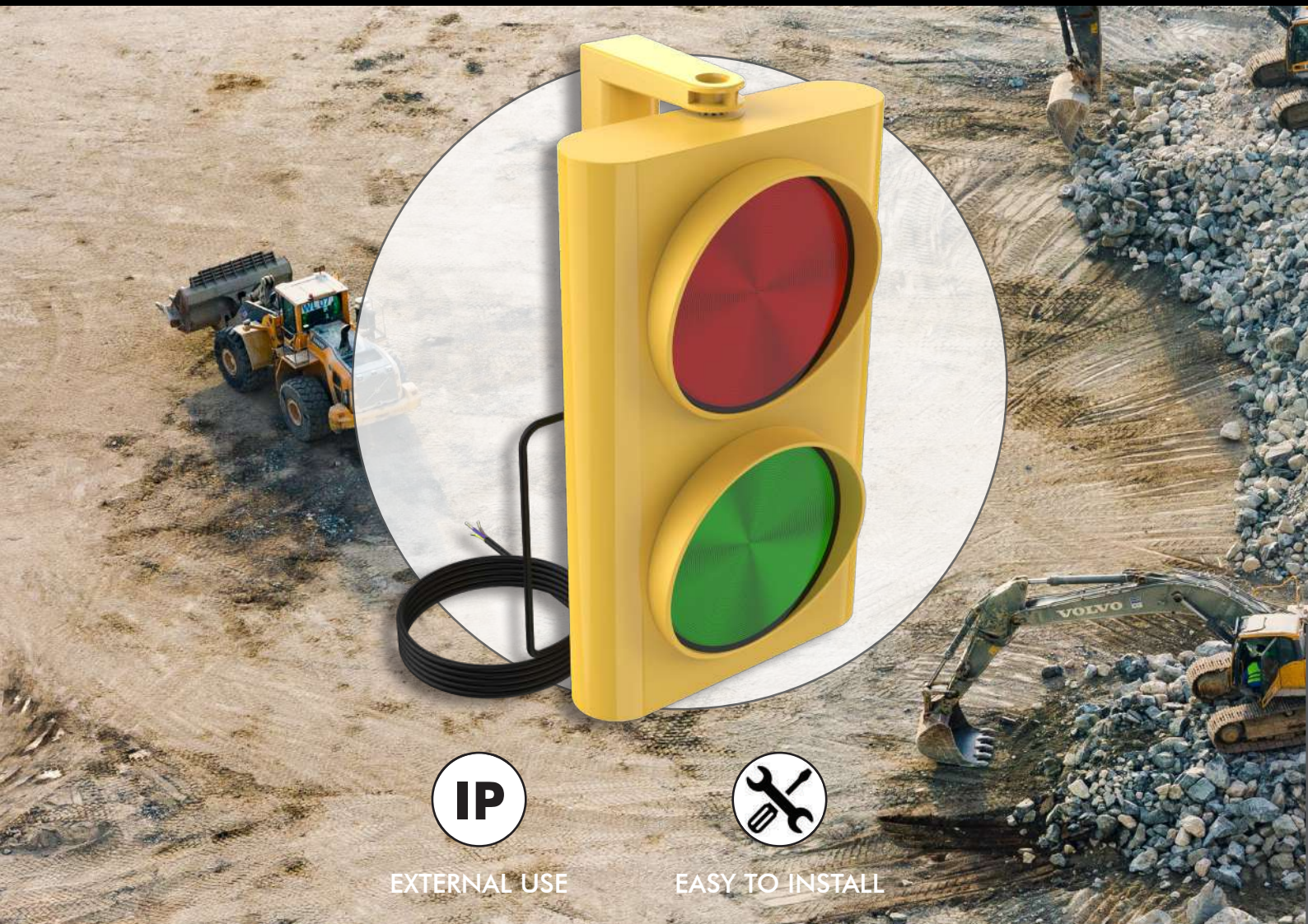

H120cm -
pcs.48



TECHNICAL DATA	ASFERA80Y Traffic light set, 2 lights	ASFERA80DY Directional vertical traffic light, 2 lights	ASFERA80OY Horizontal traffic light, 2 lights	ASFERA80ODY Directional horizontal traffic light, 2 lights
Power supply	24V	24V	24V	24V
Rated absorbed current	0,13A	0,13A	0,13A	0,13A
Power	1,50W	1,50W	1,50W	1,50W
Brightness	120lx (+10lx)	120lx (+10lx)	120lx (+10lx)	120lx (+10lx)
Working temperature	-20/+55°	-20/+55°	-20/+55°	-20/+55°
IP	66	66	66	66
Number of LEDs	40	40	40	40

ERA80 YELLOW TRAFFIC LIGHT

This traffic light is designed to meet high safety standards, with an attractive yet simple design. It is a signaling product suitable for different contexts: pedestrian crossings, parking lots, entrances in residential contexts.

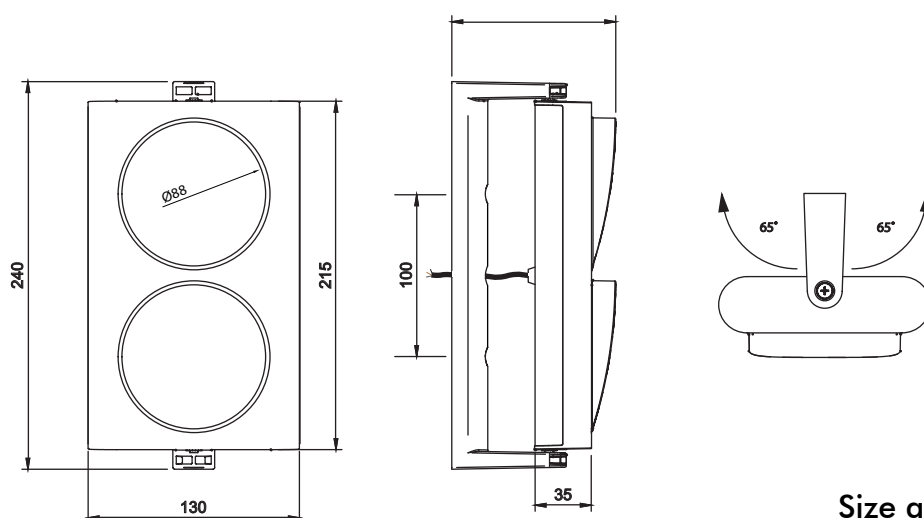
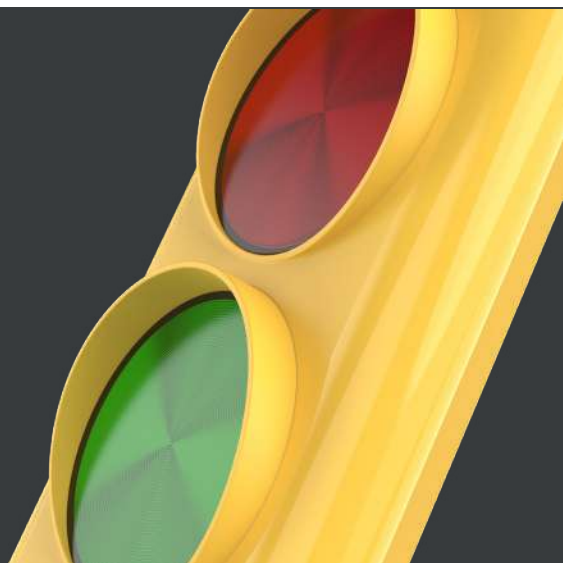

Size and bulk

Accessories



ASFERA80SP

Brackets for pole mounting

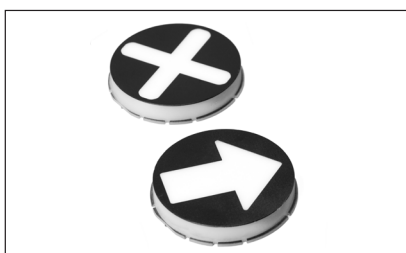

ASFERA80LD

Directional lenses kit



APS

Galvanized pole (Ø60mm)

ERA801 L

YELLOW



EXTERNAL USE



EASY TO INSTALL

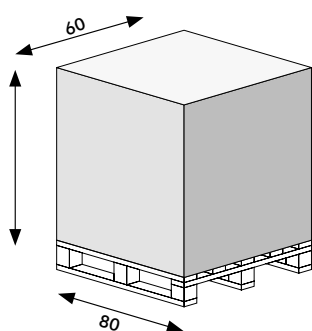

H120cm -
pcs.96



TECHNICAL DATA	ASFERA801LRY	ASFERA801LVY	ASFERA801LGY
Power supply	24V	24V	24V
Rated absorbed current	0,13A	0,13A	0,13A
Power	1,50W	1,50W	1,50W
Brightness	120lx (+10lx)	120lx (+10lx)	120lx (+10lx)
Working temperature	-20/+55°	-20/+55°	-20/+55°
IP	66	66	66
Number of LEDs	40	40	40

VERTICAL WITH
BRACKET

VERTICAL WITHOUT
BRACKET



ASFERA801LRVY TWINCOLOR

Double coloring (red-green)
in one body with 40 LEDs (20 + 20) integrated.

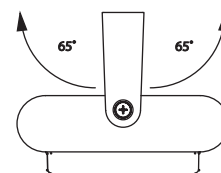
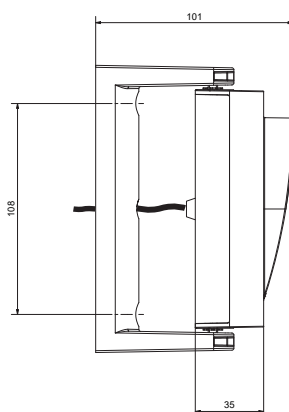
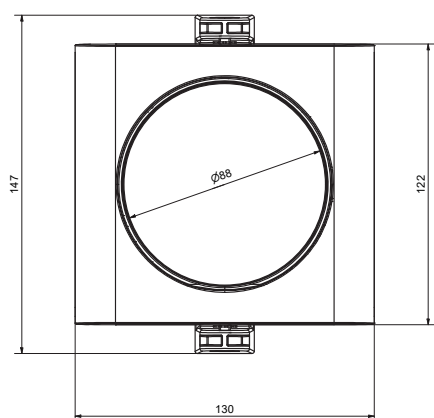
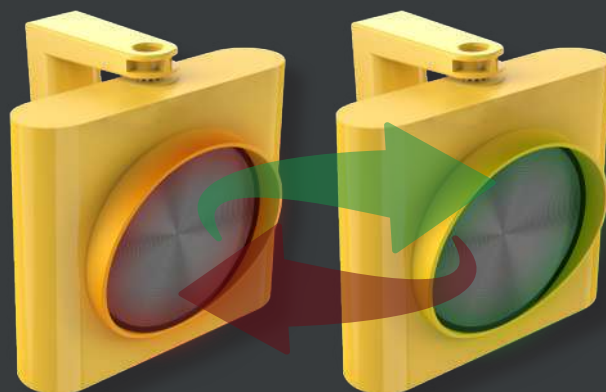

Size and bulk

Accessories



ASFERA80SP

Brackets for pole mounting

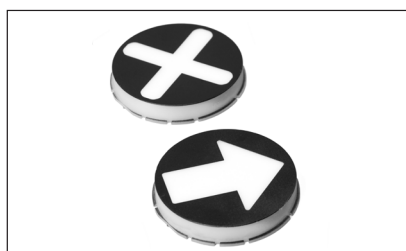

ASFERA80LD

Directional lenses kit



APS

Galvanized pole (Ø60mm)

CHRONOS



—  — MADE IN ITALY —

SIZE AND BULK

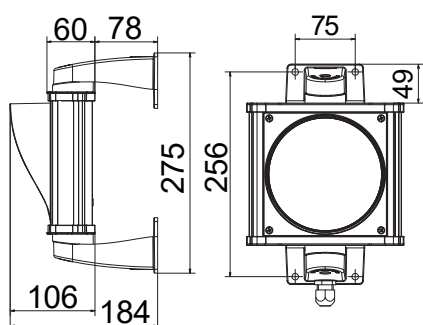

1-LIGHT TRAFFIC LIGHT

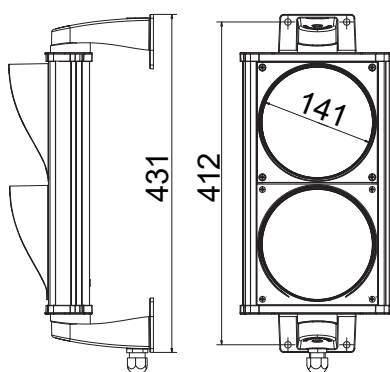

2-LIGHTS TRAFFIC LIGHT

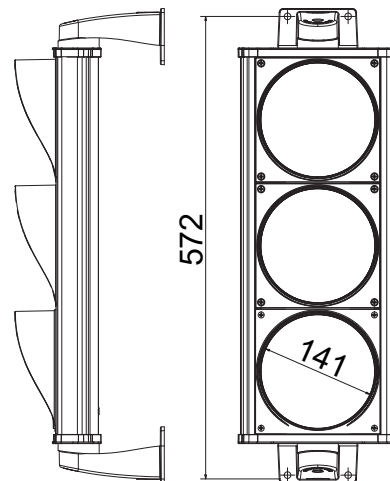

3-LIGHTS TRAFFIC LIGHT

FIELDS OF APPLICATION



GARAGES



LOGISTICS

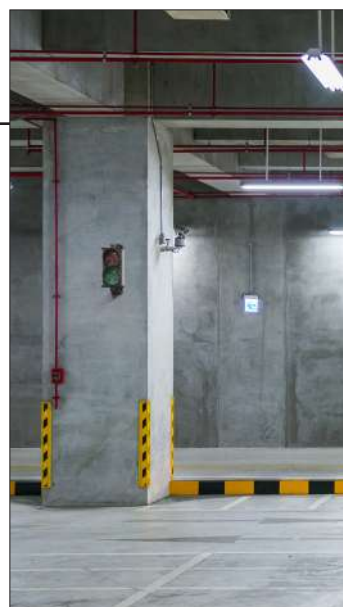

CAR PARK

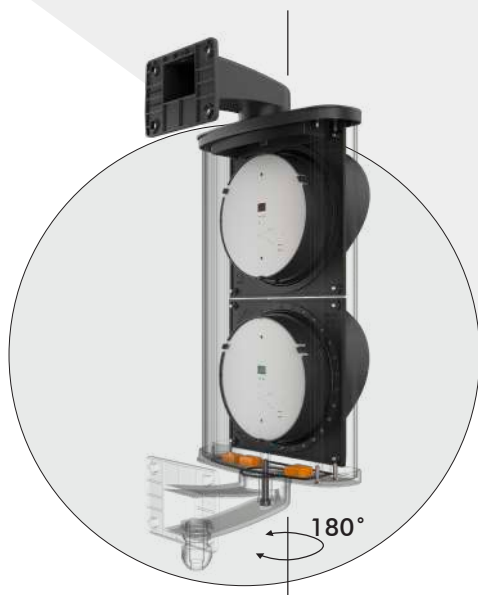

ROTATABLE AT 180° AND HIDDEN CABLE PASSAGE WITHIN THE BRACKET FOR MAXIMUM SAFETY.

CHRONOS
Composed of an aluminum profile, powder coated with internal reinforcements, technopolymer covers, for unsurpassed stiffness and mechanical resistance. Joint lens and sunshield, only one piece both waterproof and anti-leaking.



A multivoltage traffic light, easy to wire as it automatically detects the incoming voltage (from 24 to 230V), 24 LEDs per lamp for optimal brightness, possibility to remove the electronics from the front, for both repair and maintenance works.

ACCESSORIES



CHRSM

55mm short bracket kit, 5mm for Chronos.



AMPS

Pair of brackets for hooking the traffic light onto the pole.



APS

Galvanized pole (Ø60mm) for traffic light support, length 3m.

Apollo

ALUMINUM



MADE IN ITALY



EXTERNAL USE





ROTATABLE AT 200°



EASY TO INSTALL



ANTI-VANDALIC

Product	Code	Power supply (V)	Power (W)	Color	Number of lights	Brightness (lx)	Working Temperature (C°)	Number of LED's by color	Ø Lens mm	Protection (IP)	Weight (kg)	Pallet pcs.		
	ASF25L1R	24V ac/dc	2	●	1	50 (±5)	-30/+80°	25	120	65	1.42	72		
	ASF25L1G			●										
	ASF25L1V			●										
	ASF25L1R230	230V ac	5	●		900	-30/+80°	BULB			1.50			
	ASF25L1G230			●										
	ASF25L1V230			●										
	ASF1R	230V ac	70	●									1.50	
	ASF1G			●										
ASF1V	●													
	ASF25L2RV	24V ac/dc	2	● ●	2	50 (±5)	-30/+80°	25	120	65	2.85	48		
	ASF25L2RVC			● ●										
	ASF25L2RR			● ●										
	ASF25L2RVD	230V ac	5	● ●		900	-30/+80°	BULB					3.20	
	ASF50L1RV-01			● ●										
	ASF25L2RR230			● ●										
	ASF25L2RV230	230V ac	70	●										
	ASF50L1RV230-01			●										
	ASF25L2RV230D			●										
	ASF25L2RVC230	230V ac	70	●										
	ASF2RV			●										
	ASF25L3GRV			● ●										
	ASF25L3GRV230	230V ac	5	●	3	50 (±5)	-30/+80°	25	120	65	3.42	36		
	ASF3GRV		70	●							900			BULB

**BULK SIZE
AND PALLET**

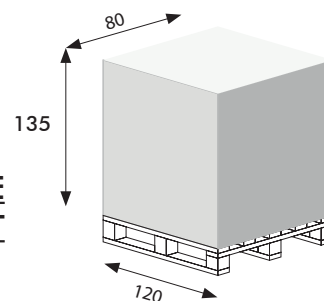

SIZE AND BULK

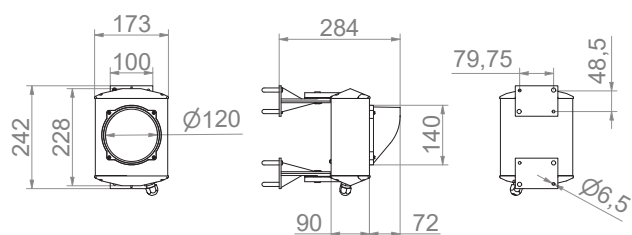
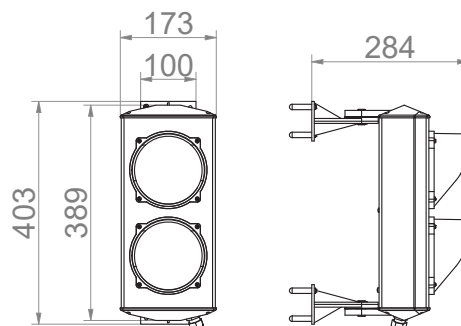
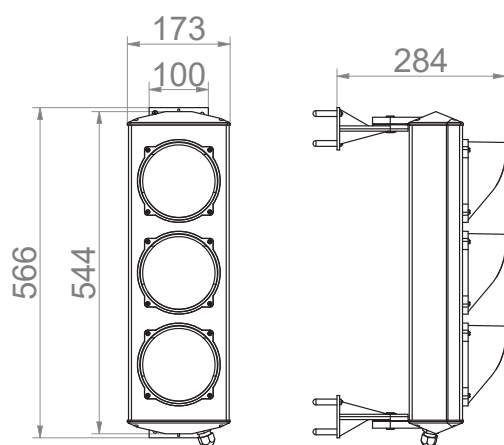
**1 LAMP TRAFFIC LIGHT****2 LAMP TRAFFIC LIGHT****3 LAMP TRAFFIC LIGHT**

FIELDS OF APPLICATION

AIRPORTLOGISTICSCONSTRUCTION SITES



TWIN COLOR
TRAFFIC LIGHT
CODE: ASF50L1RV-01
ASF50L1RV230-01

Double coloring
(red-green)
in one body with **50 LEDs**
(25 + 25) integrated

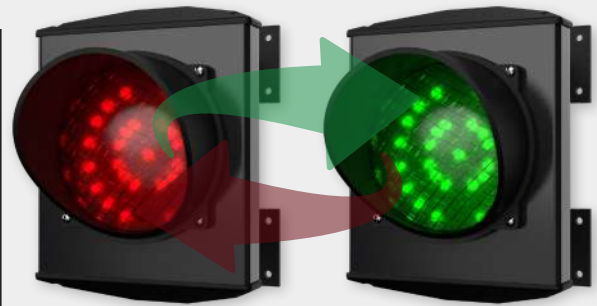

DIRECTIONAL TWO-LENS
TRAFFIC LIGHT

CODE: ASF25L2RVD
ASF25L2RV230D

Traffic light supplied with an adjustable arrow and a cross. Lens printed through a screen printing process. Neutral lens color and technical features matching those of a 2-lamps traffic lights.

TRAFFIC LIGHT WITH QUICK
MALE/FEMALE
CONNECTION

CODE: ASF25L2RVC
ASF25L2RV230C

Traffic light supplied with external quick connection with male/female coupling, same features of the 2-lamps traffic light.



ACCESSORIES

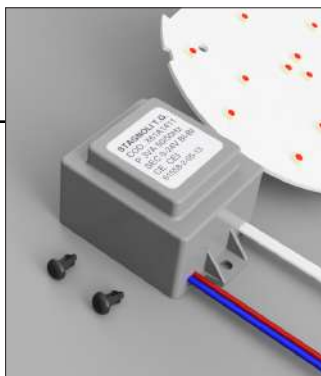

ASFK230

Conversion kit for allowing use of Apollo traffic lights from 24V to 230V.



AMPS

Pair of brackets for hooking the traffic light onto the pole.



APS

Galvanized pole (Ø60mm) for traffic light support, length 3m.



ARSFPOF-10
ARSFPOX-10

Directional lenses kit 10 pcs. Apollo.

Apollo

PLAST



MADE IN ITALY



EXTERNAL USE





ROTATABLE AT 130°



EASY TO INSTALL



ANTI-VANDALIC

Product	Code	Power supply (V)	Power (W)	Color	Number of lights	Brightness (lx)	Working Temperature (C°)	Number of LED's by color	Ø Lens mm	Protection (IP)	Weight (kg)	Pallet pcs.
	ASFR	24V ac/dc	1,5	●	1	35 (±5)	-20/+55°	18	120	65	0.60	144
	ASFG			●								
	ASFV			●								
	ASFR230	230V ac	3	●								
	ASFG230			●								
	ASFV230			●								
	ASF36L1RV	24V ac/dc	1,5	● ●	1	35 (±5)	-20/+55°	18	120	65	0.60	144
	ASF36L1RV230	230V ac	3	● ●							0.98	
	ASFRV	24V ac/dc	1,5	● ●	2	35 (±5)	-20/+55°	18	120	65	0.60	48
	ASFRV230	230V ac	3	● ●							0.98	

**BULK SIZE
AND
PALLET**

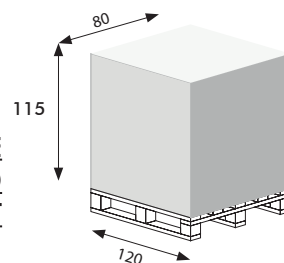

SIZE AND BULK

1- LAMPS TRAFFIC LIGHT

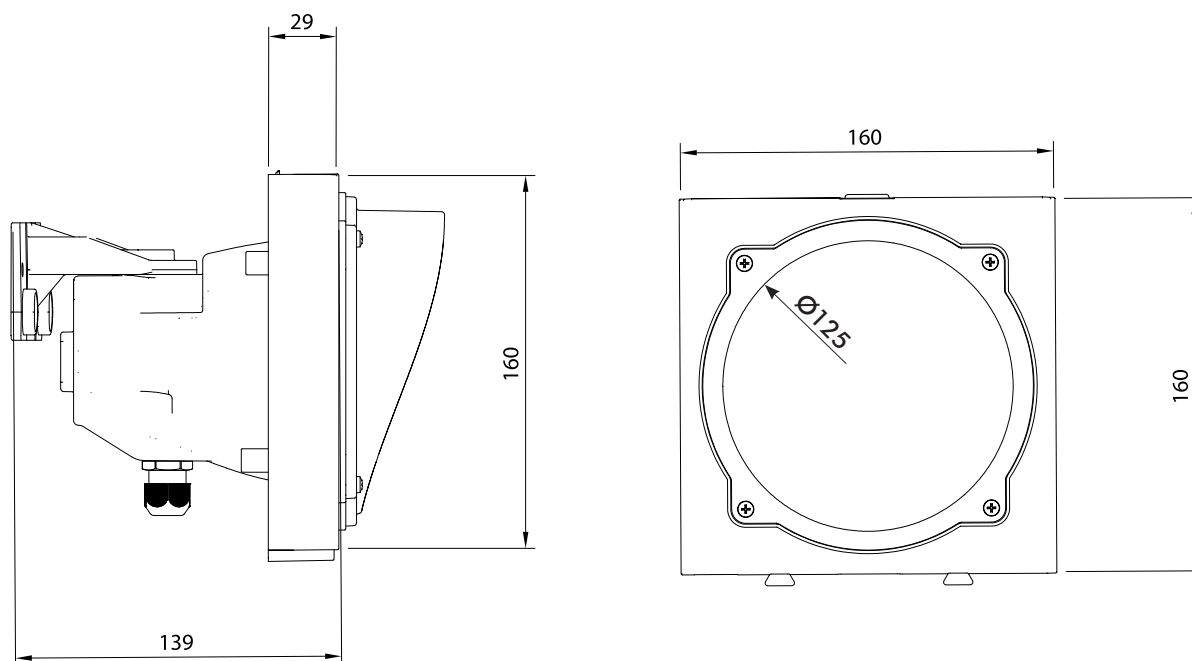

FIELDS OF APPLICATION



AIRPORT



LOGISTICS



CONSTRUCTION SITES



TWIN COLOR
TRAFFIC LIGHT
CODE: ASF36L1RV
ASF36L1RV230

Double coloring
(red-green) in one body with
36 LEDs (18+18) integrated.



MODULARITY OF BODIES

The clips placed
below the traffic light allow
for easy modulation of the
traffic light, from 2 to 3
bodies.

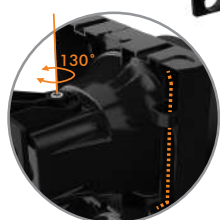

CHANNEL CLIP

for hiding the cable and prevent its
visibility.



ACCESSORIES

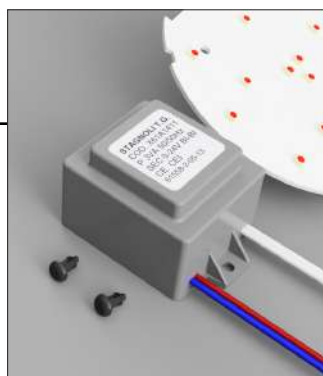

ASFK230

Conversion kit for
allowing use of Apollo
traffic lights from 24V
to 230V.



AMPS

Pair of brackets for
hooking the traffic light
onto the pole.



APS

Galvanized pole
(Ø60mm) for traffic
light support,
length 3m.



ARSFPOF-10
ARSFPOX-10

Directional lenses
kit 10 pcs. Apollo.

APOLLO PLAST

YELLOW



EXTERNAL USE



ROTATABLE AT 130°



EASY TO INSTALL



ANTI-VANDALIC

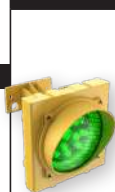

Product	Code	Power supply (V)	Power (W)	Color	Number of lights	Brightness (lx)	Working Temperature (C°)	Number of LED's by color	Ø Lens mm	Protection (IP)	Weight (kg)	Pallet pcs.
	ASFRY	24V ac/dc	1,5	●	1	35 (±5)	-20/+55°	18	120	65	0.60	144
	ASFGY			●								
	ASFVY			●								
	ASFR230Y	230V ac	3	●								
	ASFG230Y			●								
	ASFV230Y			●								
	ASF36L1RVY	24V ac/dc	1,5	● ●	1	35 (±5)	-20/+55°	18	120	65	0.60	144
	ASF36L1RV230Y	230V ac	3	● ●							0.98	
	ASFRVY	24V ac/dc	1,5	● ●	2	35 (±5)	-20/+55°	18	120	65	0.60	48
	ASFRV230Y	230V ac	3	● ●							0.98	



**TWIN COLOR
TRAFFIC LIGHT**

**CODE: ASF36L1RVY
ASF36L1RV230Y**

Double coloring
(red-green) in one body with
36 LEDs (18+18) integrated.

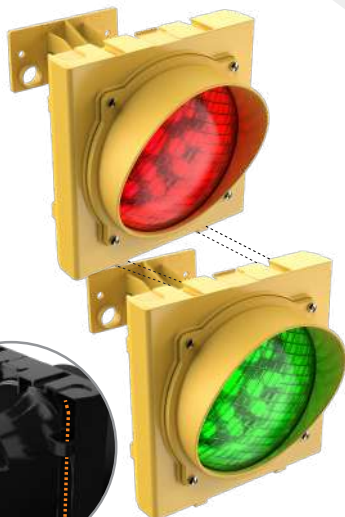

MODULARITY OF BODIES

The clips placed
below the traffic light
allow for easy modulation of the
traffic light, from 2 to 3
bodies.



CHANNEL CLIP

for hiding the cable and prevent its
visibility.

FIELDS OF APPLICATION



MINES



QUARRY



CONSTRUCTION SITES



CUSTOMIZATIONS OF OUR PRODUCTS

ON CUSTOMER DEMAND, STAGNOLI OFFERS A LENS CUSTOMIZATION SERVICE FOR THE PRODUCTS: APOLLO, APOLLO PLAST.

ARSFPO-08



ARSFPO-05



ARSFPO-02



ARSFPO-04



ARSFPO-10



ARSFPO-09



ARSFPO-06



ARSFPO-03



STOP

ARSFPO-07



ARSFPO-01





	APOLLO ALUMINUM	APOLLO PLAST	CHRONOS	ERA80
MATERIALS	ALLUMINUM + NYLON	NYLON	ALLUMINUM	POLYCARBONATE
NUMBER OF LED'S	25	18	18	40
BRIGHTNESS [LX]	50	40	70	120
IP	65	65	66	56
MODULAR	×	✓	×	×
POWER SUPPLY [V AC/DC]	24/230	24/230	24 , 230	24
CABLE PASSAGE	EXTERNAL	EXTERNAL	INTERNAL	EXTERNAL
LENT SIZE [MM]	120	120	120	80
CUSTOM LENS	✓	✓	×	✓

LAMPS

FOR DOCKING STATIONS



EXTERNAL USE



EAST TO INSTALL

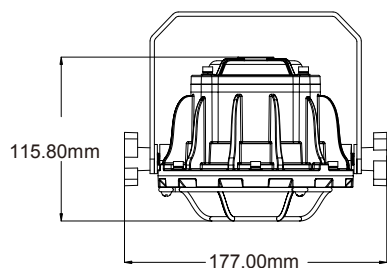

LED lamps system from 30W to 50W for docking stations, configurable with single 100-150cm and double 100-150cm supports.

ALPDC30**ROUND LED LOADING DOCK LIGHT 30W**

CODE	POWER (W)	POWER SUPPLY (Vac)	BRIGHTNESS (lm)	PROTECTION (IP)	BEAM ANGLE	WEIGHT (kg)
ALPDC30	30	100-240	3300	65	110°	1,60

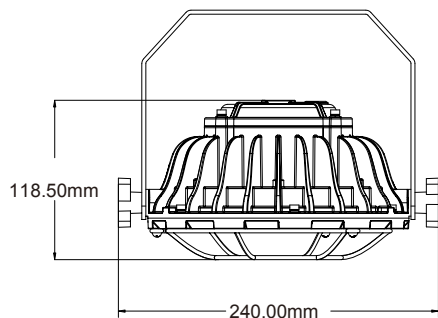
ALPDC50**ROUND LED LOADING DOCK LIGHT 50W**

CODE	POWER (W)	POWER SUPPLY (Vac)	BRIGHTNESS (lm)	PROTECTION (IP)	BEAM ANGLE	WEIGHT (kg)
ALPDC50	50	100-240	5500	65	110°	2,52

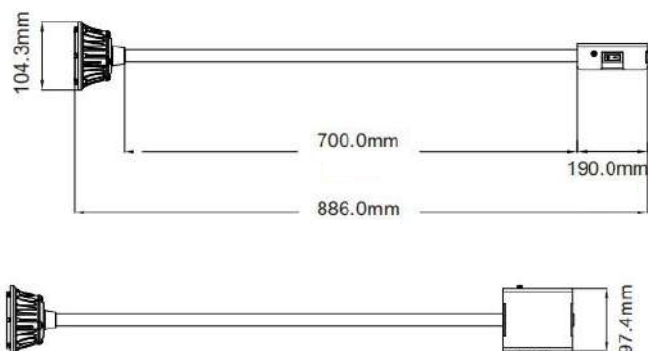
ALPDF20**LED GOOSENECK DOCK LIGHT 20W**

CODE	POWER (W)	POWER SUPPLY (Vac)	BRIGHTNESS (lm)	PROTECTION (IP)	BEAM ANGLE	WEIGHT (kg)
ALPDF20	20	100-240	3000	65	20°	2,56

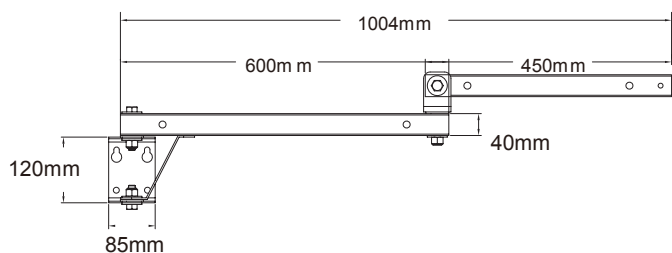
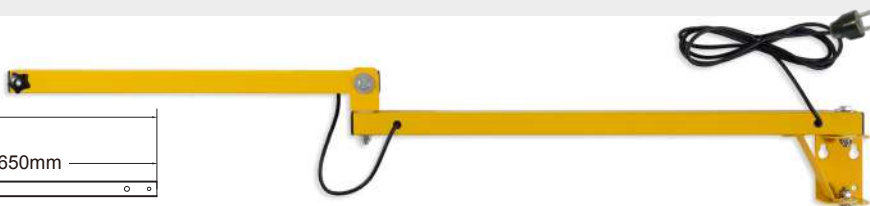
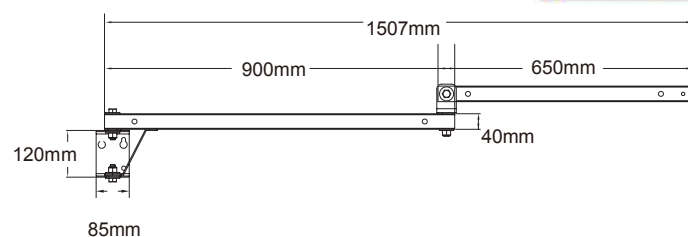
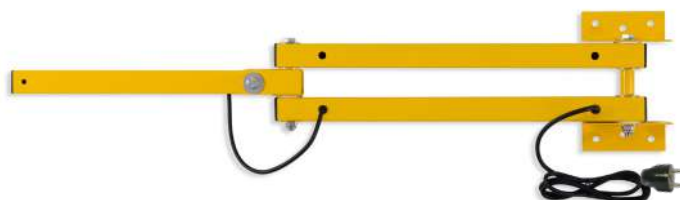
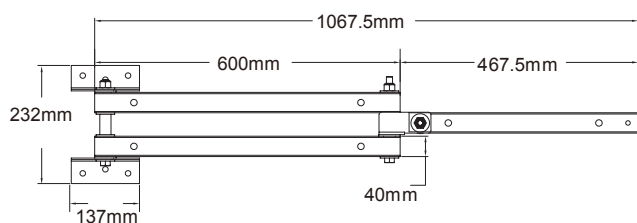
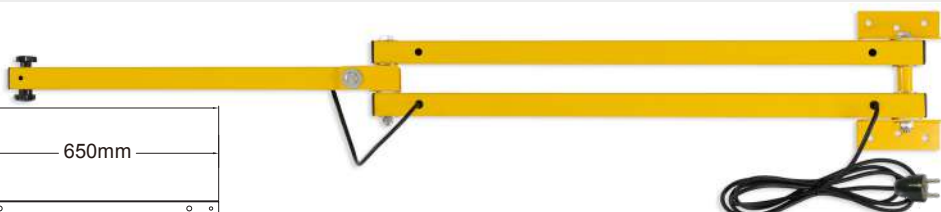
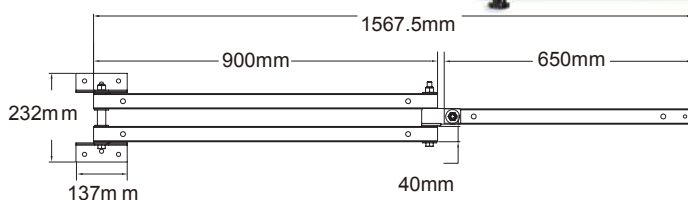
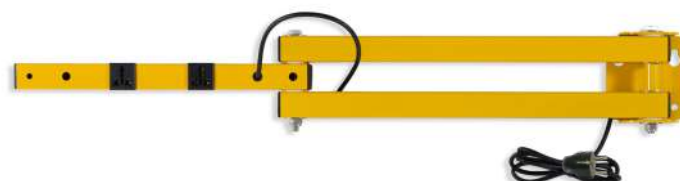
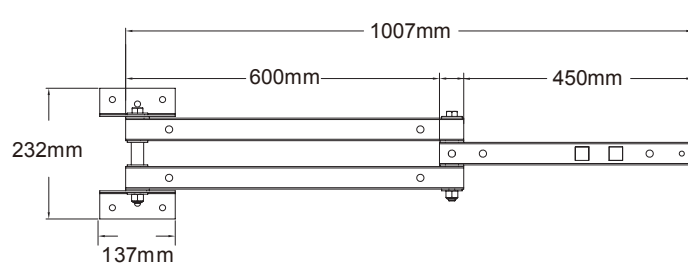
ALPDB100S**BRACKET SINGLE ARM 100CM****ALPDB150S****BRACKET SINGLE ARM 150CM****ALPDB100D****BRACKET DOUBLE ARM 100CM****ALPDB150D****BRACKET DOUBLE ARM 150CM****ALPDB100DP****BRACKET DOUBLE ARM 100CM BUILT-IN RECEPTACLE**

PEGASUS



MADE IN ITALY

APNL



APAL



APGL



Pegasus LED flashing light with integrated antenna and multi-power supply

Multi voltage 12-24-230V ac/dc

- Steady or flashing light
- Design (2003 Design Award)
- Integrated antenna (433MHz)

ACCESSORIES



KAFPG

Gray wall fixing support, complete with screws and gaskets

SATURNO

1Km
485

WEB
APP

10

IFLIGHT
MAFORI
FEU

WIFI
NET

PRIORITY
TIME BASED
CAR COUNTER
GREEN
WAVE

AUX
CONTACT



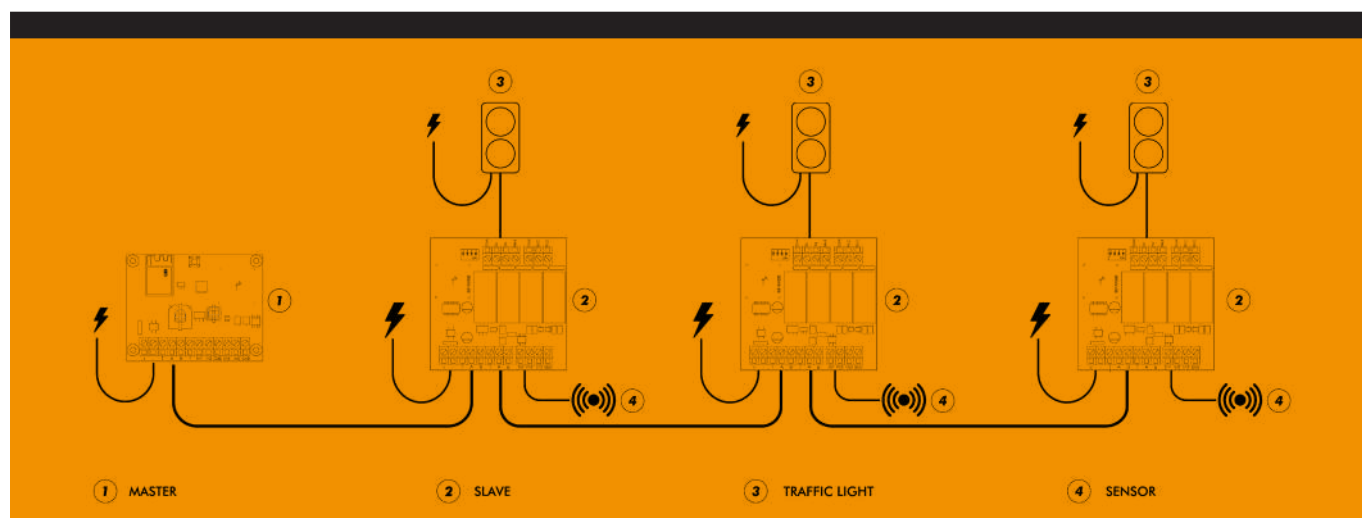

Code		Power supply	Working time	Protection
		(V)	(C°)	(IP)
SATURNO-S	Slave	230	-20/+ 50°	45
SATURNO-M	Master			
SATURNO-K	Kit: 1 master, 2 Slave			



Saturno is a control panel created for satisfying all kinds of installers' requests. From integrated time management to area management for up to 10 traffic lights for each installation. All these features have been improved thanks to a 2.0 technology, without any help from third parties. Simply use the internal wi-fi network included in the Saturno panel.



MULTI-FLOOR PARKING LOTS MANAGEMENT



MULTI-ENTRANCE PARKING LOTS MANAGEMENT



ALTERNATE ONE-WAY MANAGEMENT

ACNSEM3L



The ACNSEM3L is a card for handling two traffic lights with 2 or 3 lamps. It allows to equally manage 12-24 or 230 V ac/dc lanterns.

With its two modes of operation, the first one being cyclical and time based and the other one logics-priority based with external sensors, it is particularly suitable for managing alternate merges, especially on ramps or slides with poor visibility.

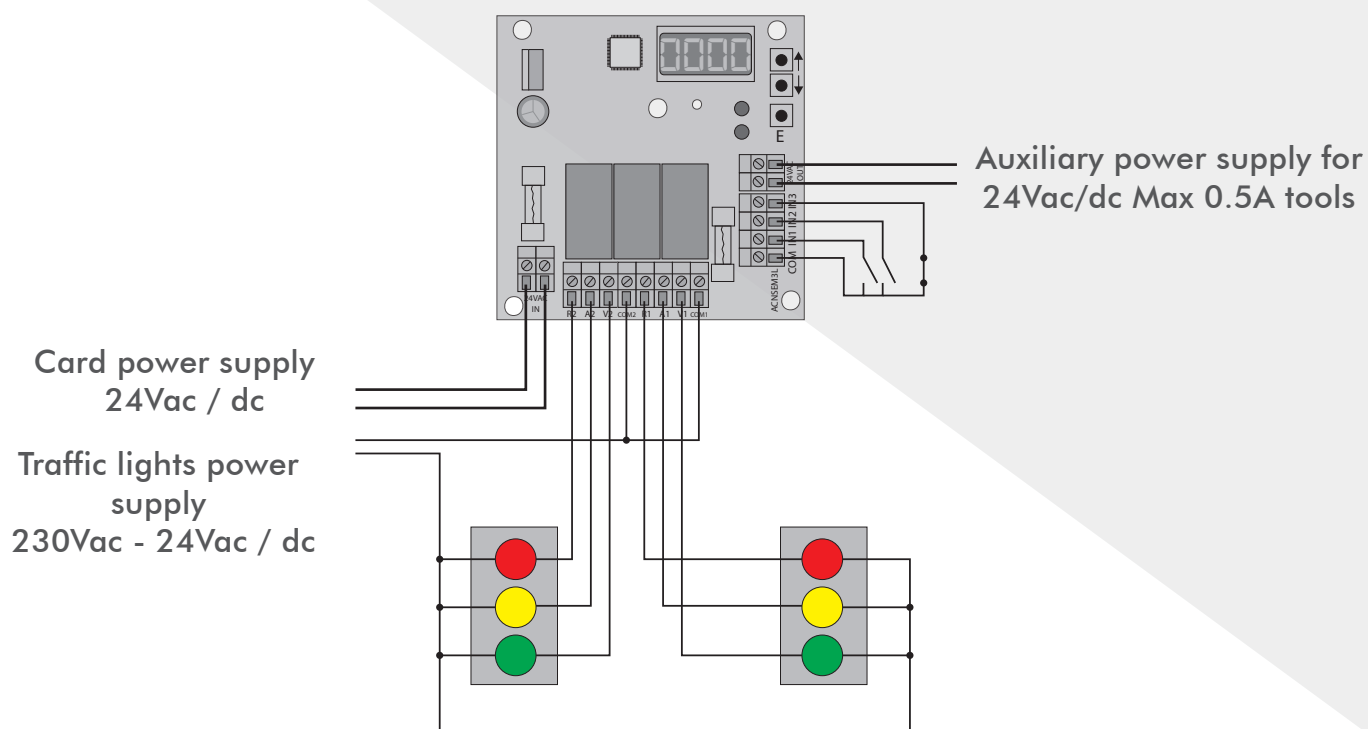

Code	Power supply
	(V)
ACNSEM3L	24
ACNSEM3L230	230

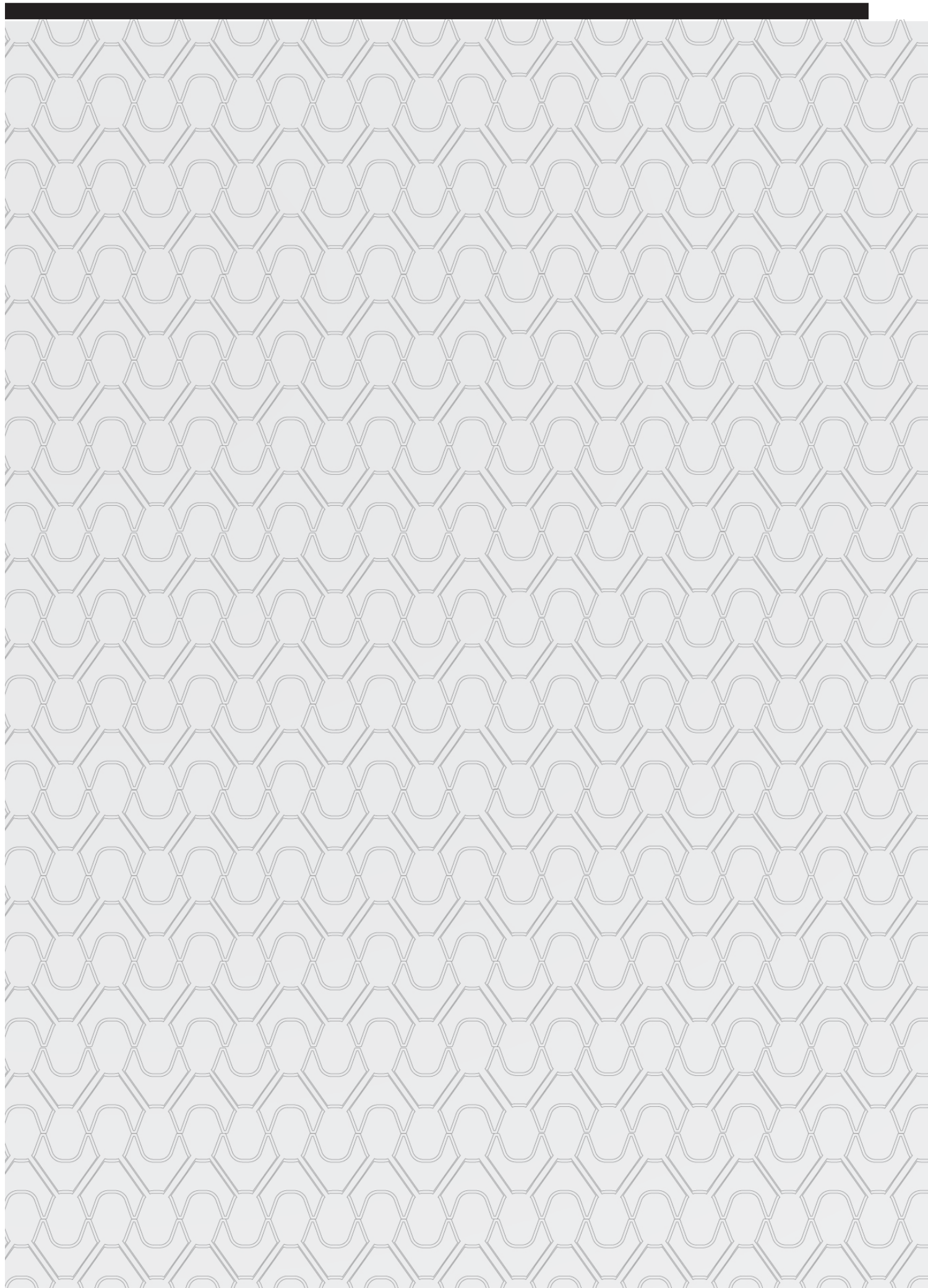

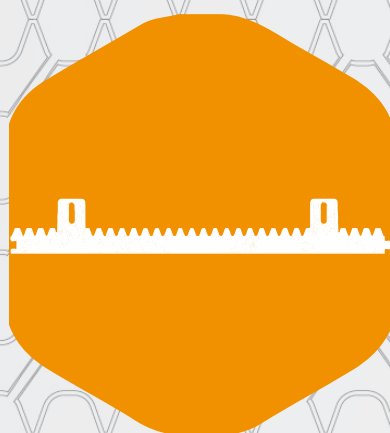

RACKS

**NYLON
STEEL**

45

**46
60**

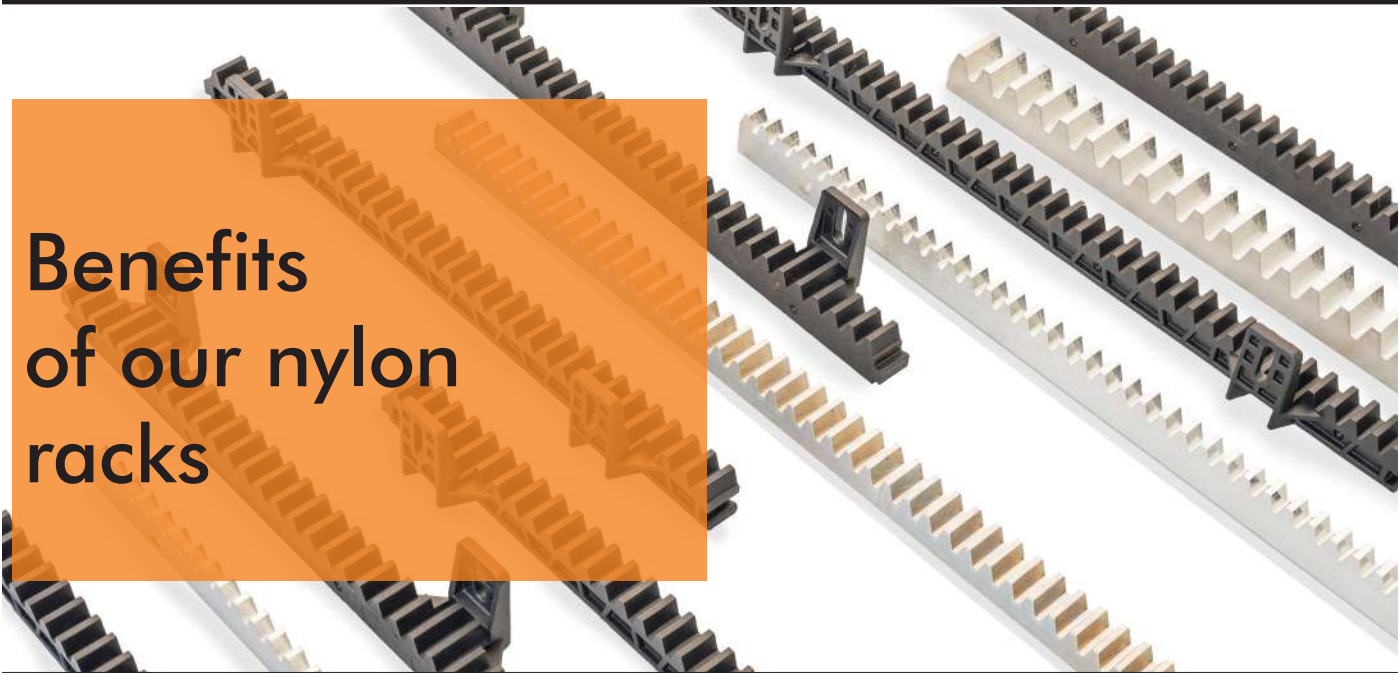

Benefits of our nylon racks

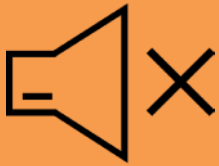

Silent



Self-lubricating



Light



Rust-proof

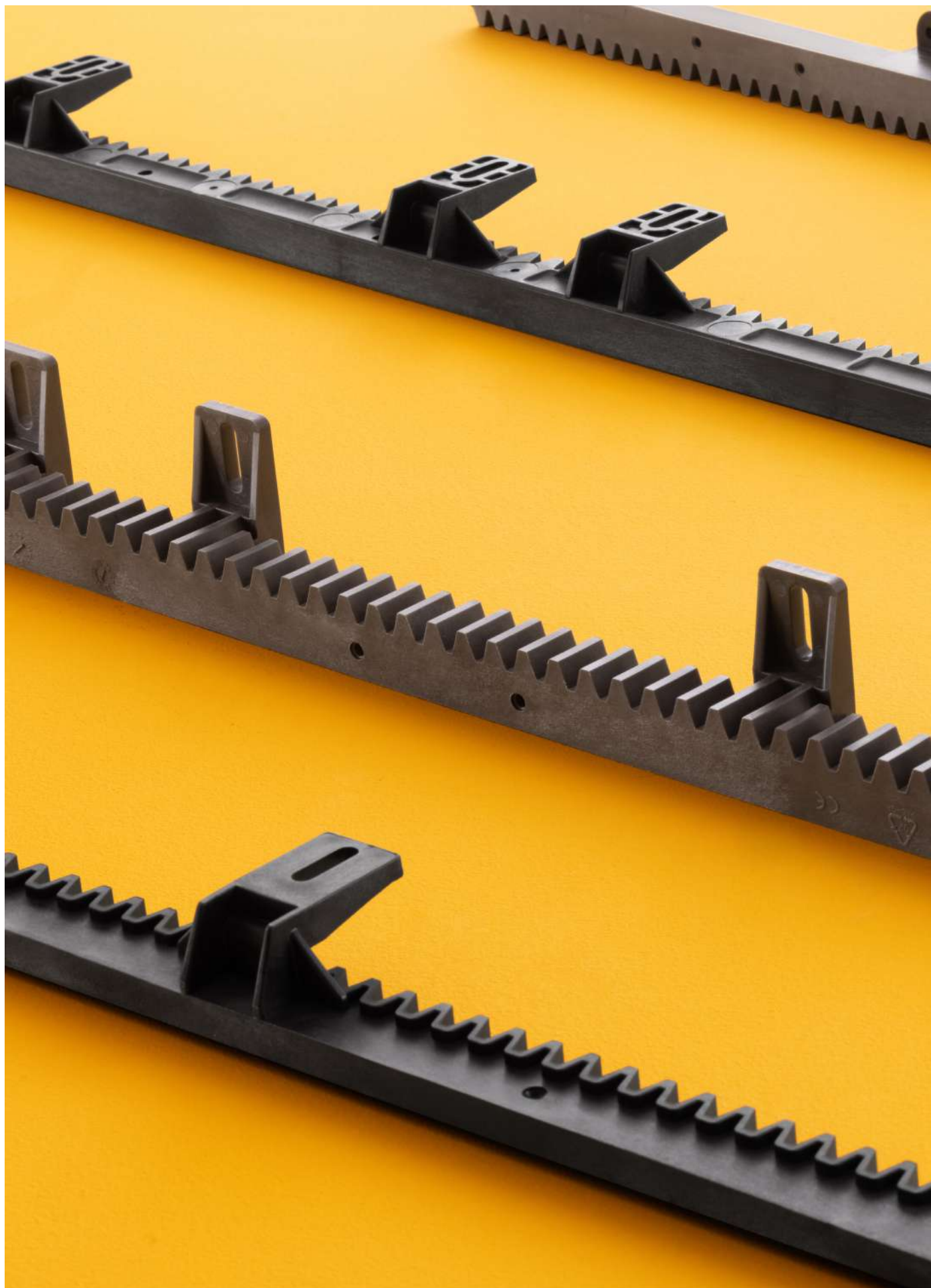

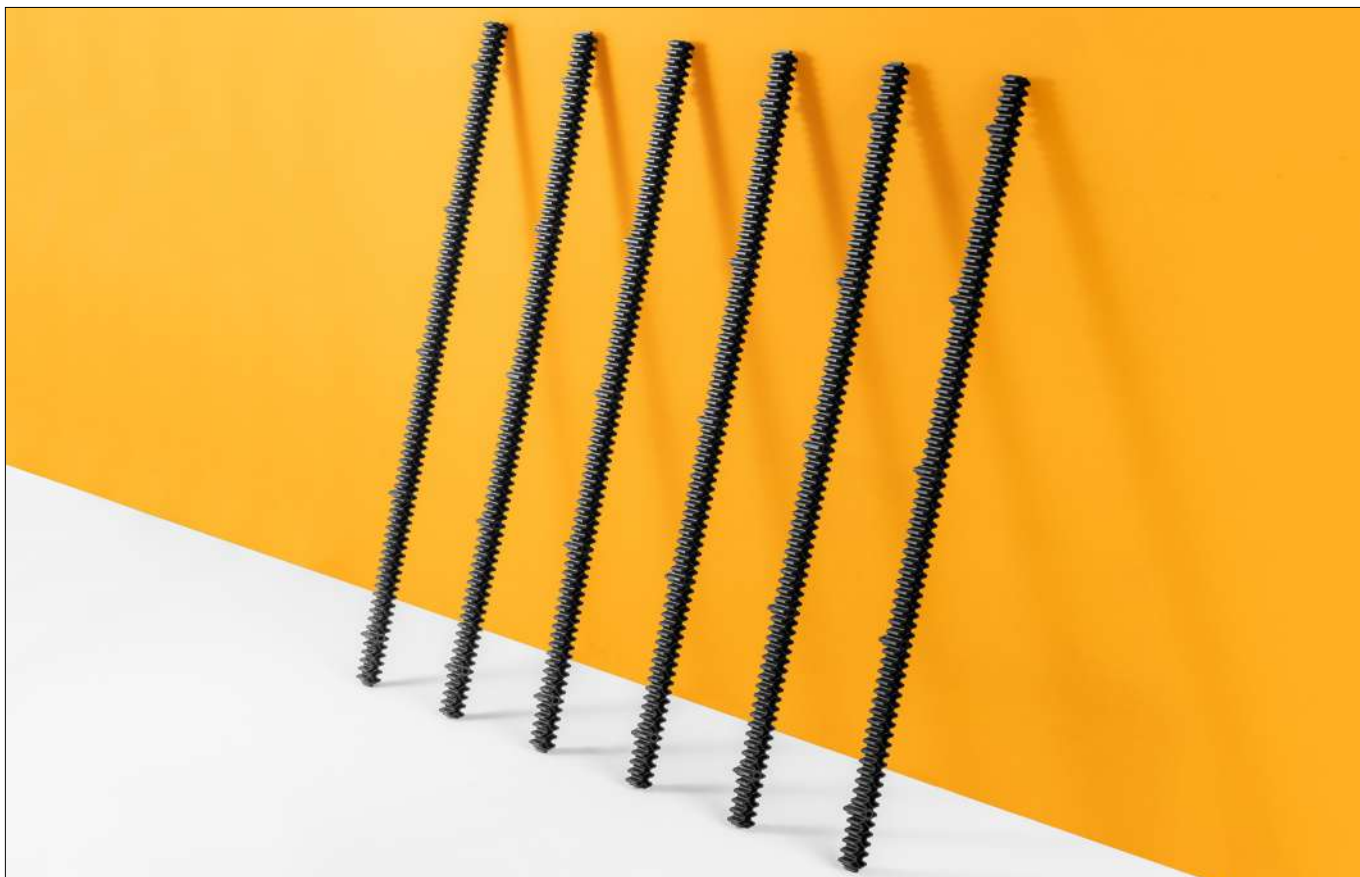

Rack **without steel core**, entirely in technopolymer, thanks to the geometries studied by Stagnoli, it is completely deformation-proof. **The presence of 5 central attachments and dual toothting** allows for use of the rack in both directions without distinction, making it perfectly symmetrical. This rack is tested for gates with a maximum capacity of **500Kg**.

New rack **ACRN5**

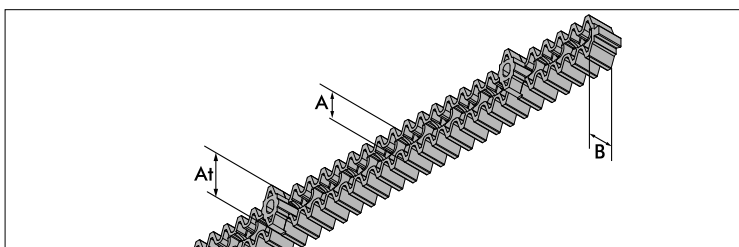
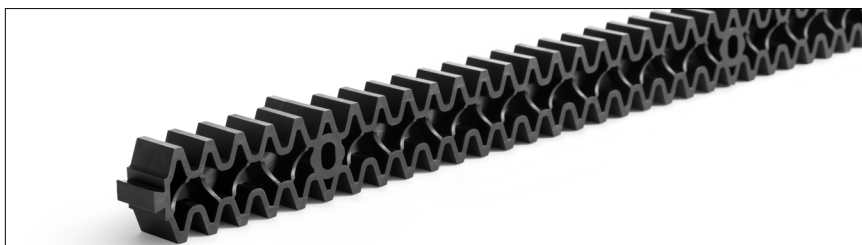

AVAILABLE ACCESSORIES

- SACN5

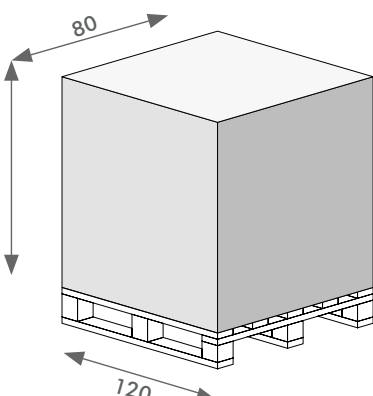

SIZE AND PALLET BULK

Rack/Pallet
1020 m - h 100 cm

ACRN5	
B Width:	20 mm
A Part height:	14 mm
Total height:	32 mm
Length:	1000 x 6=(6000)mm
Weight:	0,36x6=(2,16)kg
Range:	500 Kg
Number of fit:	5

S6-1200

M4X1200 RACK, COLOR

GREY with upper attachments for gates of up to 1200Kg, thanks to reinforced hooks and the special material used for its construction.

AVAILABLE ACCESSORIES

- SAC014
- ACRFF

PALLET SIZE AND BULK

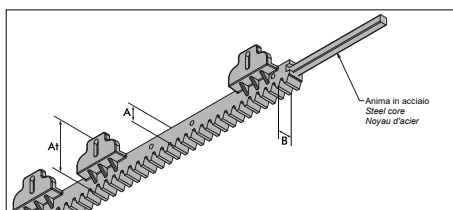
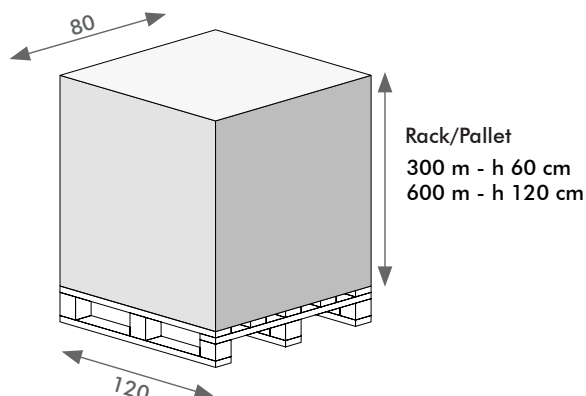

S6-1200

B Width:	20 mm
A Part height:	28 mm
Total height:	60 mm
Length:	1.000 mm
Weight:	1.336 g
Range:	1.200 Kg
Number of fit:	6

Steel core



Square shape alignment system



V6-1200

M4X1200 RACK, COLOR

GREY with lower cantilevered attachments for gates up to 1200Kg, thanks to reinforced hooks and the special material used for its construction.

AVAILABLE ACCESSORIES

- SAC014
- ACRFF

PALLET SIZE AND BULK

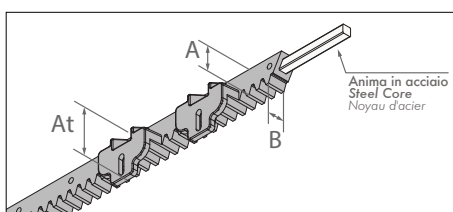
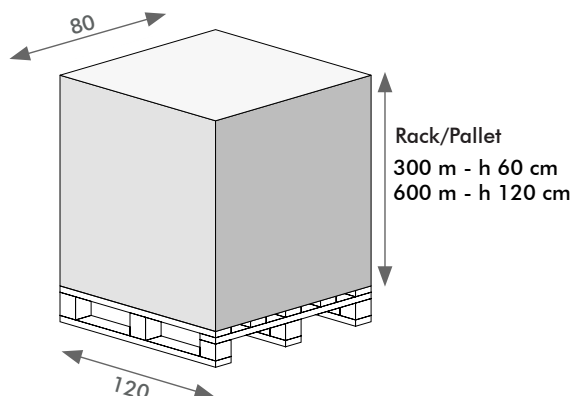

V6-1200

B Width:	20 mm
A Part height:	28 mm
Total height:	60 mm
Length:	1.000 mm
Weight:	1.336 g
Range:	1.200 Kg
Number of fit:	6

Steel core



Square shape alignment system



ACRV6

M4X1000 RACK, COLOR

GREY with 6 lower cantilevered attachments, for gates with a maximum capacity of 800 Kg.

AVAILABLE ACCESSORIES

- SAC012
- ACRFF

PALLET SIZE AND BULK

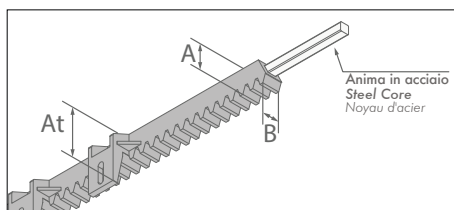
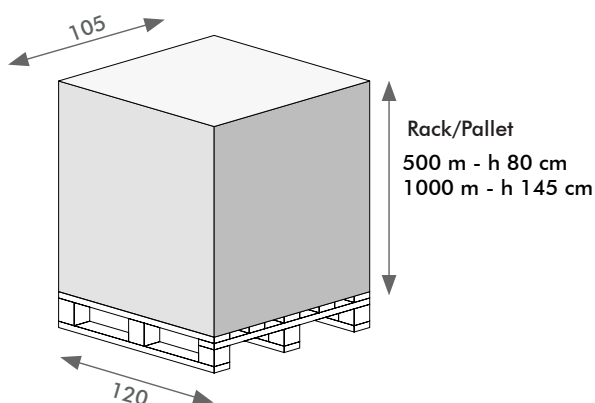

ACRV6

B Width:	20 mm
A Part height:	28 mm
Total height:	60 mm
Length:	1.000 mm
Weight:	1.328 g
Range:	800 Kg
Number of fit:	6

Steel core



Square shape alignment system



ACRV6B

M4X1000 RACK, COLOR

WHITE with 6 lower cantilevered attachments, for gates with a maximum capacity of 800 Kg.

AVAILABLE ACCESSORIES

- SAC012
- ACRFF

PALLET SIZE AND BULK

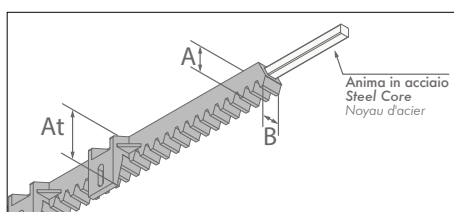
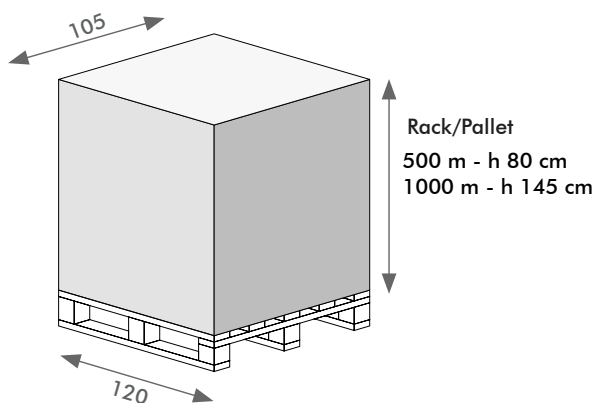

ACRV6B

B Width:	20 mm
A Part height:	28 mm
Total height:	60 mm
Length:	1.000 mm
Weight:	1.328 g
Range:	800 Kg
Number of fit:	6

Steel core



Square shape alignment system



ACRS6

M4X1000 RACK, COLOR GREY with 6 upper cantilevered attachments, for gates with a maximum capacity of 800 Kg.

AVAILABLE ACCESSORIES

- SAC012
- ACRFF

PALLET SIZE AND BULK

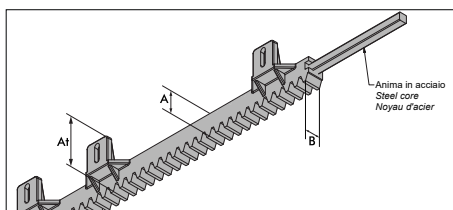
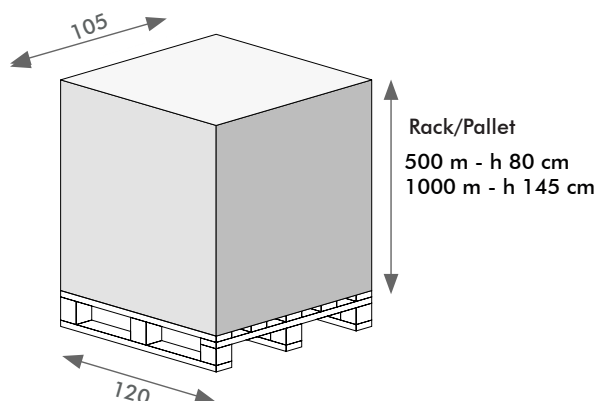

ACRS6

B Width:	20 mm
A Part height:	28 mm
Total height:	60 mm
Length:	1.000 mm
Weight:	1.318 g
Range:	800 Kg
Number of fit:	6

Steel core



Square shape alignment system



ACRS6N

M4X1000 RACK, COLOR BLACK with 6 upper cantilevered attachments, for gates with a maximum capacity of 700 Kg.

AVAILABLE ACCESSORIES

- SAC012
- ACRFF

PALLET SIZE AND BULK

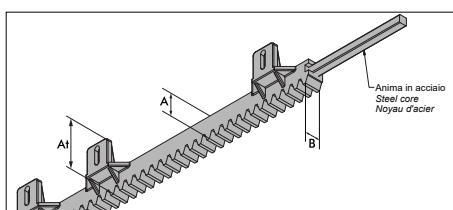
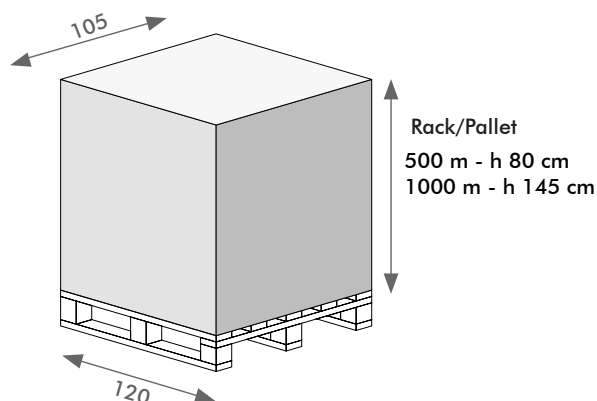

ACRS6N

B Width:	20 mm
A Part height:	28 mm
Total height:	60 mm
Length:	1.000 mm
Weight:	1.318 g
Range:	700 Kg
Number of fit:	6

Steel core



Square shape alignment system



ACRN6

M4X1000 RACK, COLOR

BLACK with 6 lower cantilevered attachments, for gates with a maximum capacity of 700 Kg.

AVAILABLE ACCESSORIES

- SAC012
- ACRFF

PALLET SIZE AND BULK

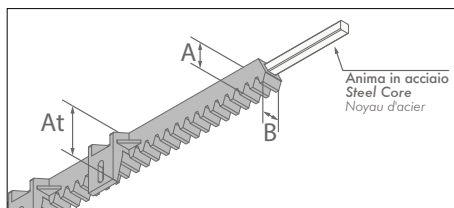
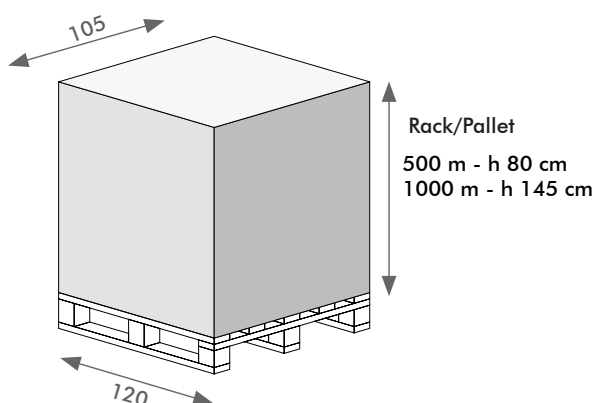

ACRN6

B Width:	20 mm
A Part height:	28 mm
Total height:	60 mm
Length:	1.000 mm
Weight:	1.328 g
Range:	700 Kg
Number of fit:	6

Steel core



Square shape alignment system



N6C - N6CH

M4X1000 RACK, COLOR

BLACK with 6 lower cantilevered attachments, for gates with a maximum capacity of 700 Kg.

AVAILABLE ACCESSORIES

- SAC012
- ACRFF

PALLET SIZE AND BULK

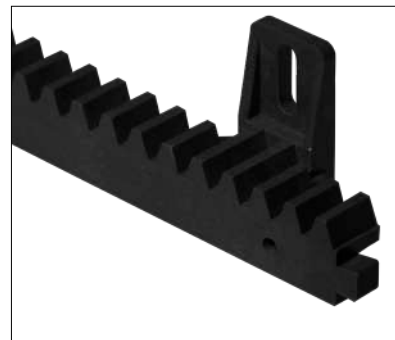
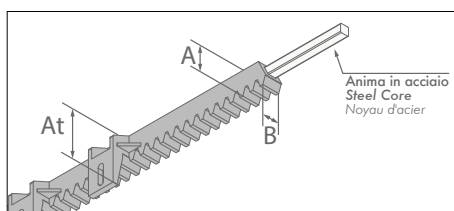
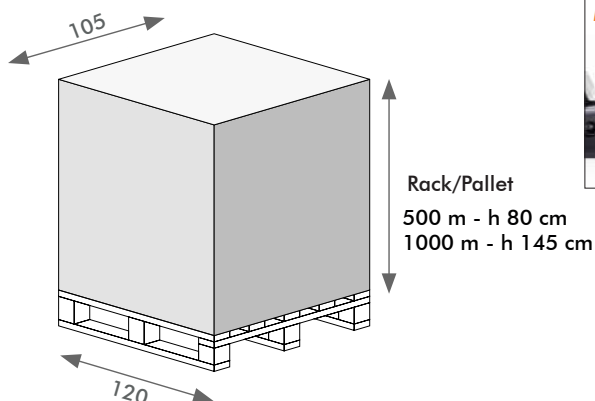

N6C



N6CH



N6C - N6CH

B Width:	20 mm
A Part height:	28 mm
Total height:	60 mm
Length:	1.000 mm
Weight:	1.328 g
Range:	700 Kg
Number of fit:	6

Steel core



Overtail alignment system





ACRV4

M4X1000 RACK, COLOR

GREY with 4 lower cantilevered attachments, for gates with a maximum capacity of 500 Kg.

AVAILABLE ACCESSORIES

- SAC013
- ACRFF

PALLET SIZE AND BULK

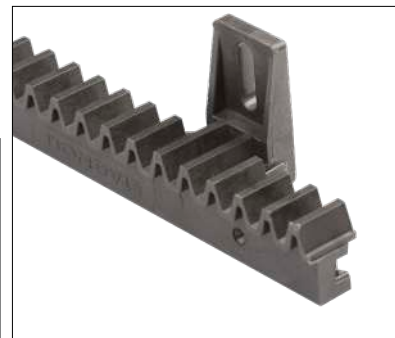
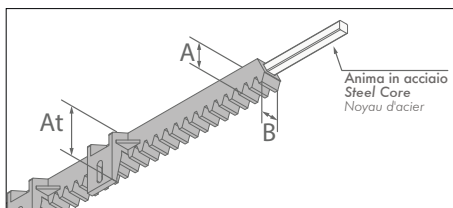
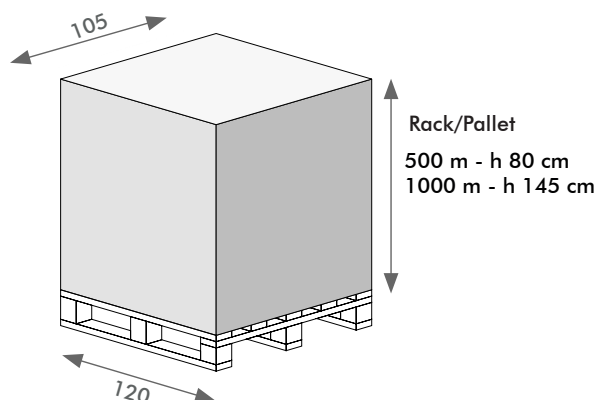

ACRV4

B Width:	20 mm
A Part height:	28 mm
Total height:	60 mm
Length:	1.000 mm
Weight:	1.318 g
Range:	500 Kg
Number of fit:	4

Steel core



Dovetail alignment system



ACRN4

M4X1000 RACK, COLOR

BLACK with 4 lower cantilevered attachments, for gates with a maximum capacity of 400 Kg.

AVAILABLE ACCESSORIES

- SAC013
- ACRFF

PALLET SIZE AND BULK

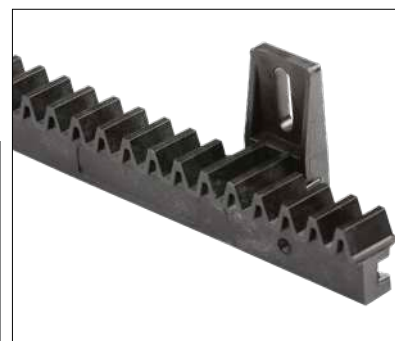
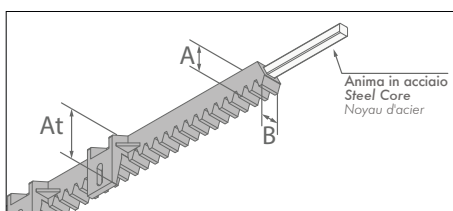
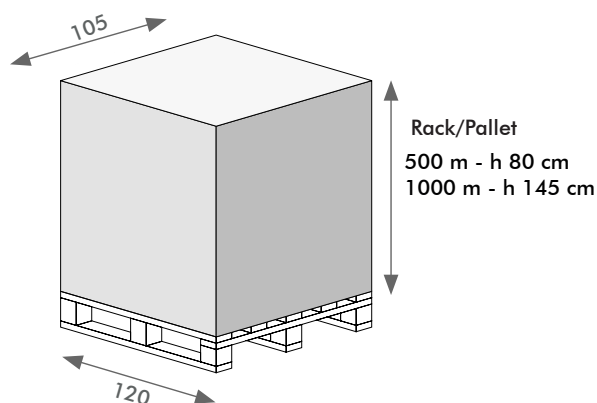

ACRN4

B Width:	20 mm
A Part height:	28 mm
Total height:	60 mm
Length:	1.000 mm
Weight:	850 g
Range:	400 Kg
Number of fit:	4

Steel core



Dovetail alignment system



ACRV33

THREE PIECES OF GRAY M4X333 MM RACK

(not packaged) for gates with a maximum capacity of 300 Kg.

AVAILABLE ACCESSORIES

- SAC012
- ACRFF

PALLET SIZE AND BULK

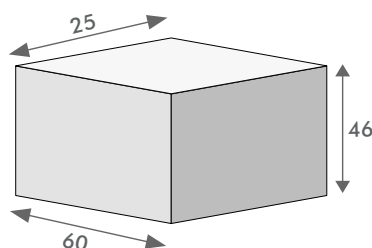

42 meter in the box

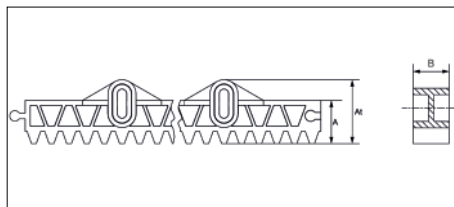

ACRV33

B Width:	20 mm
A Part height:	30 mm
Total height:	45 mm
Length:	999mm
Weight:	446=(148,6X3) g
Range:	300 Kg
Number of fit:	6

ACFCR333VP

M4X333 MM RACK

GREY COLOR (in packs of 2 meters with self-drilling screws) for gates with a maximum capacity of 300 Kg.

AVAILABLE ACCESSORIES

- SAC012
- ACRFF

PALLET SIZE AND BULK

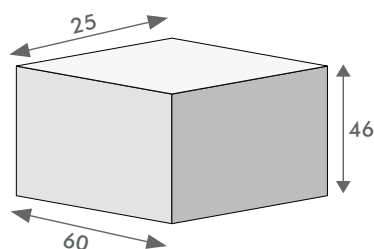

20 total pieces in the box

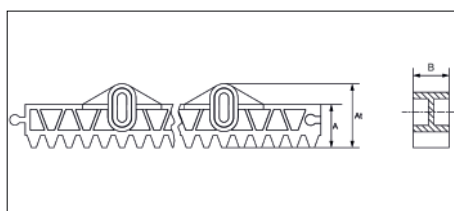

ACFCR333VP

B Width:	20 mm
A Part height:	30 mm
Total height:	45 mm
Length:	1.998mm
Weight:	892=(148,6x6)g
Range:	300 Kg
Number of fit:	6

ACRV20BL

M4X3000 MM RACK WITH PRE-DRILLED ALUMINUM PROFILE with six buttonholes (15x8 mm) for gates with a maximum capacity of 300 Kg.

AVAILABLE ACCESSORIES

- SAC012
- ACRFF

PALLET SIZE AND BULK

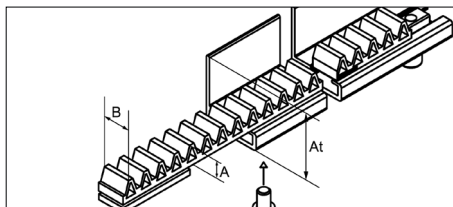
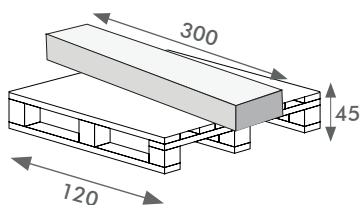

ACRV20BL

B Width:	20 mm
A Part height:	15 mm
Total height:	48 mm
Length:	3.000 mm
Weight:	3.335 g
Range:	300 Kg
Number of fit:	7

AKTCSSP1

Two pieces, glass fiber reinforced nylon **M4X1000 MM** rack, for aluminum profiles. for gates with a maximum capacity of 300 Kg.

AVAILABLE ACCESSORIES

- ACRFF

PALLET SIZE AND BULK

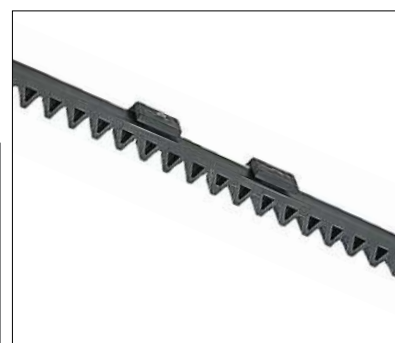
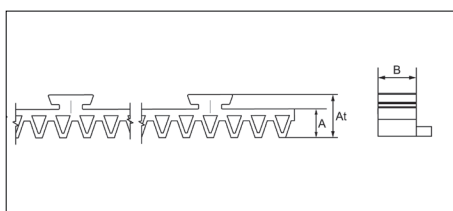
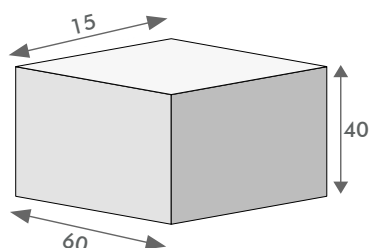

AKTCSSP1

B Width:	20 mm
A Part height:	15 mm
Total height:	21 mm
Length:	978=(489X2)mm
Weight:	280=(140x2)g
Range:	300 Kg
Number of fit:	0

2 pieces x 500mm
Total 60 meter in the box

AKTCSSP1-01

Two pieces, glass fiber reinforced nylon **M4X1000 MM** rack, for aluminum profiles. for gates with a maximum capacity of 300 Kg.

AVAILABLE ACCESSORIES

- ACRFF

PALLET SIZE AND BULK

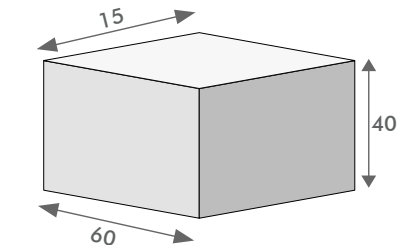

2 pieces x 500mm
Total 60 meter in the box

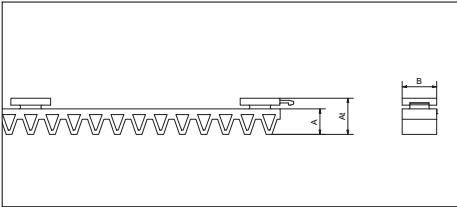

AKTCSSP1-01	
B Width:	20 mm
A Part height:	15 mm
Total height:	21 mm
Length:	978=(489X2)mm
Weight:	280=(140x2)g
Range:	300 Kg
Number of fit:	0

ACRS20Z

M4X1000 RACK AND GALVANIZED STEEL PROFILE with upper attachment, for gates with a maximum capacity of 300 Kg.

AVAILABLE ACCESSORIES

- ACRFF
- ACRSCUN

PALLET SIZE AND BULK

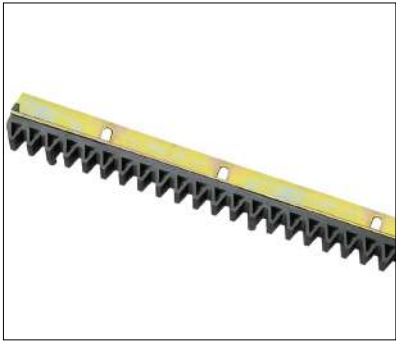
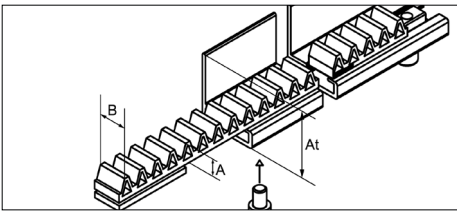
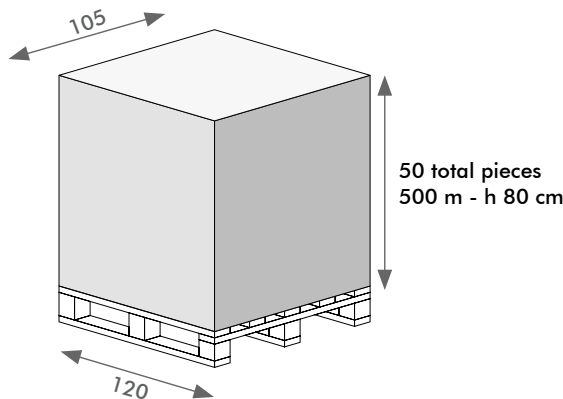

ACRS20Z	
B Width:	20 mm
A Part height:	15 mm
Total height:	48 mm
Length:	1.000 mm
Weight:	3.335 g
Range:	300 Kg
Number of fit:	0

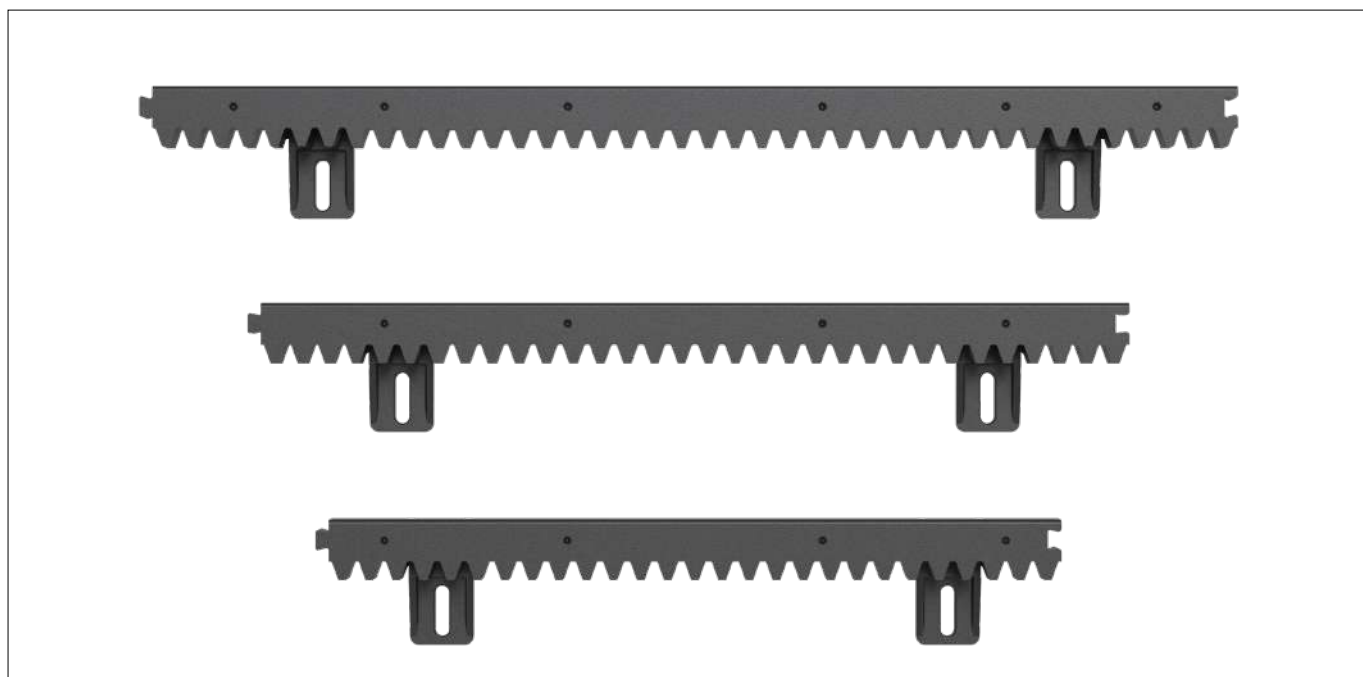

N233 - N240 - N250

Stagnoli presents its new line of modular gate racks.

Specifically, these are nylon racks, with steel core, module 4, compatible with all automations, available in different lengths. Suitable for automation kits, ideal for shipping, for storage and for GDO or DIY markets.

N233K



N240K



N250K

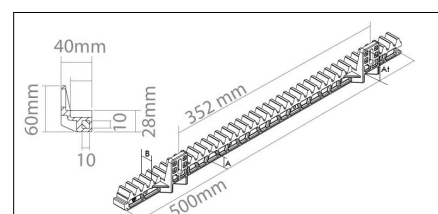
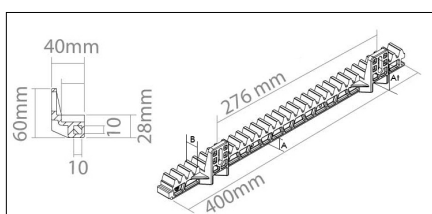
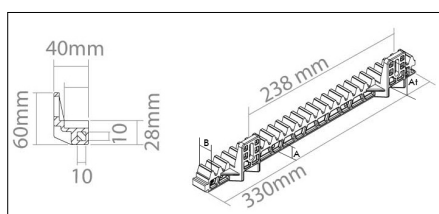

Overtail alignment system



Steel core

AVAILABLE ACCESSORIES

- SAC012
- ACRFF

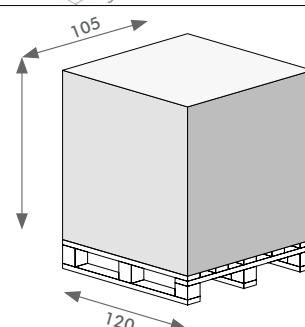

Rack/Pallet

500 m - h 80 cm
700 m - h 105 cm
1000 m - h 145 cm

	B WIDTH	PART. HEIGHT A	HEIGHT TOTAL	LENGTH	WEIGHT	RANGE	NUMBER OF FIT
N233K	19mm	19mm	59mm	330mm	380g	700kg	2
N240K	19mm	19mm	59mm	400mm	450g	700kg	2
N250K	19mm	19mm	59mm	500mm	550g	700kg	2

Rack accessories

	<p>SACN5 ACRN5 Rack fixing kit. 30 screws (5 screws per meter of rack)</p>	 <p>X 6 X 18</p>	<p>SAC014 Rack fixing kit, 6 connections. 18 screws (ACRVA) + 6 washers (ACRR)</p>
	<p>SAC012 Rack fixing kit, 6 connections. 10 sets of 6 screws (ACRVA) + 6 washers (ACRR)</p>		<p>SAC013 Rack fixing kit, 4 connections. 10 sets of 4 screws (ACRVA) + 4 washers (ACRR)</p>
	<p>ACRFF Pair of steel end- of-stroke cams</p>		<p>ACRSCUN Pair of nylon end- of-stroke cams (compatible with ACRS20Z rack)</p>
	<p>AKTBLO Terminal block for aluminum sheet - 2pcs.(compatible with the ACRV20BL rack)</p>		



CODE	CAPACITY	NUMBER OF FIT (m)	STEEL CORE	WEIGHT	LENGHT
S6-1200	1.200 KG	6	✓	1.336 g	1.000 mm
V6-1200	1.200 KG	6	✓	1.336 g	1.000 mm
ACRV6	800 KG	6	✓	1.328 g	1.000 mm
ACRV6B	800 KG	6	✓	1.328 g	1.000 mm
ACRS6	800 KG	6	✓	1.318 g	1.000 mm
ACRS6N	800 KG	6	✓	1.318 g	1.000 mm
ACRN6	700 KG	6	✓	1.328 g	1.000 mm
N6C	700 KG	6	✓	1.328 g	1.000 mm
N6CH	700 KG	6	✓	1.328 g	1.000 mm
N250K	700 KG	4	✓	550 g	1.000 mm
N240K	700 KG	4	✓	450 g	1.000 mm
N233K	700 KG	4	✓	380 g	1.000 mm
ACRN5	500 KG	5	✗	360 g	1.000 mm
ACRV4	500 KG	4	✓	1.318 g	1.000 mm
ACRN4	400 KG	4	✓	850 g	1.000 mm
ACRV33	300 KG	6	✗	446 g	999 mm
ACFCR333VP	300 KG	6	✗	892 g	1.998 mm
AKTCSSP1	300 KG	✗	✗	280 g	978 mm
AKTCSSP1-01	300 KG	✗	✗	280 g	978 mm

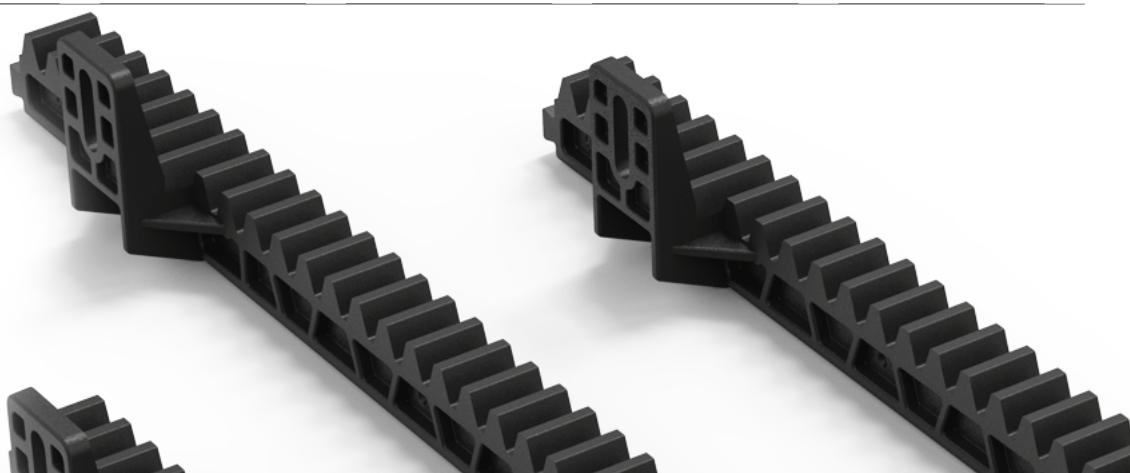

ACRM2

M4 30X8X1000mm RACK
in galvanized steel, complete with
accessories, for gates with a maximum
capacity of 1200 Kg.
With screws included (3pcs x m)

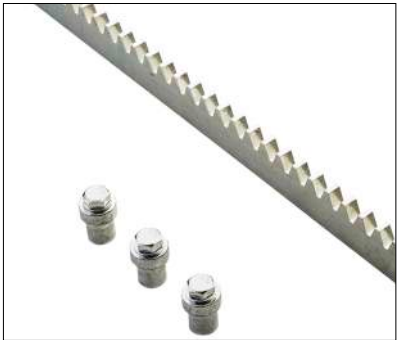
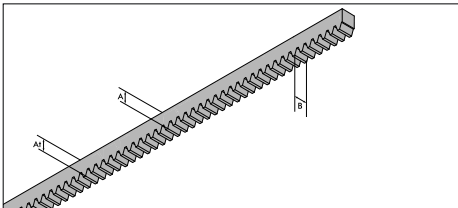

PALLET SIZE AND BULK

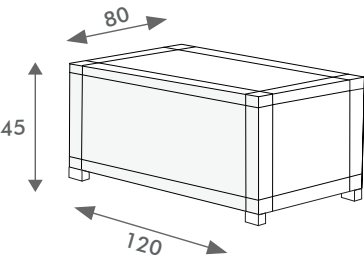

500 total pieces

ACRM2	
B Width:	8 mm
A Part height:	30 mm
Total height:	30 mm
Length:	1.000 mm
Weight:	1.700 g
Range:	1.200 Kg
Number of fit:	3

ACRM3

M4 30X12X1000mm RACK
in galvanized steel, complete with
accessories, for gates with a maximum
capacity of 2200 Kg. 4 meter pack.
With screws included (3pcs x m)

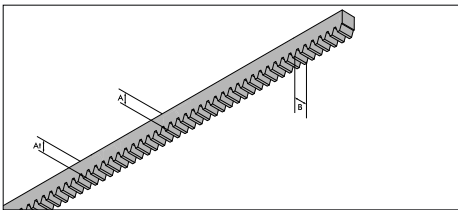

PALLET SIZE AND BULK

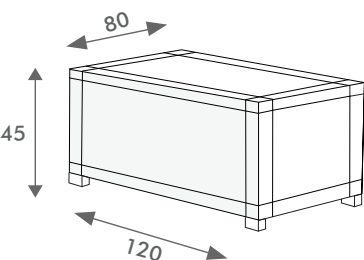

500 total pieces

ACRM3	
B Width:	12 mm
A Part height:	30 mm
Total height:	30 mm
Length:	1.000 mm
Weight:	2.530 g
Range:	2.200 Kg
Number of fit:	3



ACRM3-2000

M4 30X12X2000mm RACK
in galvanized steel, complete with
accessories, for gates with a maximum
capacity of 2200 Kg. 4 meter pack.
With screws included (3pcs x m)

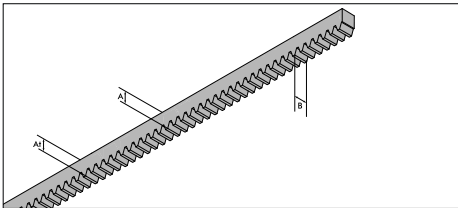

PALLET SIZE AND BULK

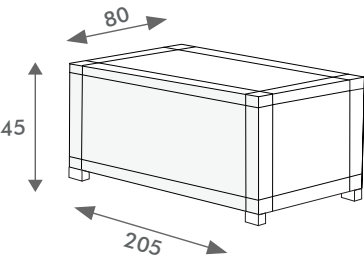

250 total pieces

ACRM3-2000	
B Width:	12 mm
A Part height:	30 mm
Total height:	30 mm
Length:	2.000 mm
Weight:	4.778 g
Range:	2.200 Kg
Number of fit:	4

ACRM1

M4 22X22X1000mm RACK
in galvanized steel, complete with
accessories, for gates with a maximum
capacity of 4000 Kg. Product to be welded.
(3pcs.x m)

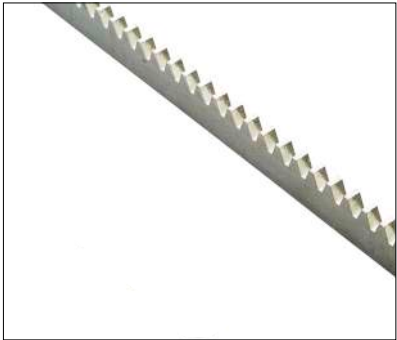
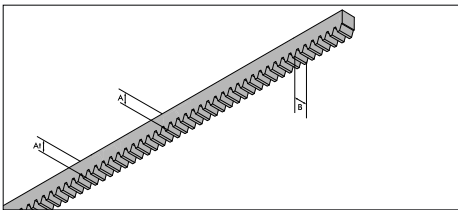

PALLET SIZE AND BULK

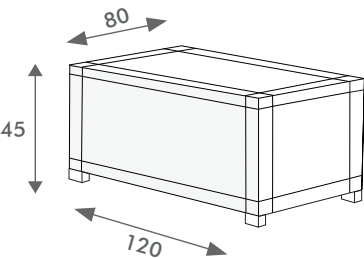

500 total pieces

ACRM1	
B Width:	22 mm
A Part height:	22 mm
Total height:	22 mm
Length:	1.000 mm
Weight:	2.400 g
Range:	4.000 Kg
Number of fit:	0

ACRM1-2000

M4 22X22X2000mm RACK
in galvanized steel, complete with accessories,
for gates with a maximum capacity of 4000 Kg.
Product to be welded. (3pcs.x m)

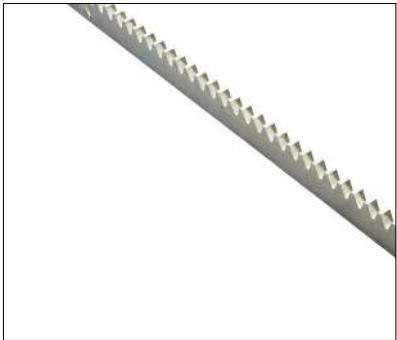
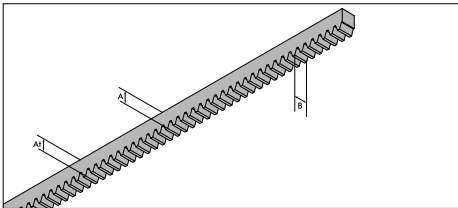

PALLET SIZE AND BULK

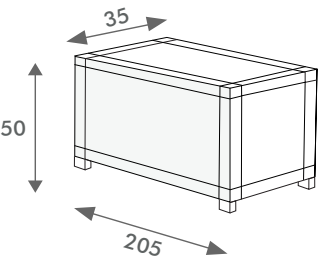

250 total pieces

ACRM1-2000	
B Width:	22 mm
A Part height:	22 mm
Total height:	22 mm
Length:	2.000 mm
Weight:	6.000 g
Range:	4.000 Kg
Number of fit:	4

ACRM6

M6 30X30X1000mm RACK
in galvanized steel, complete with
accessories, for gates with a maximum
capacity of 4000 Kg. Product to be welded.
(3pcs.x m)

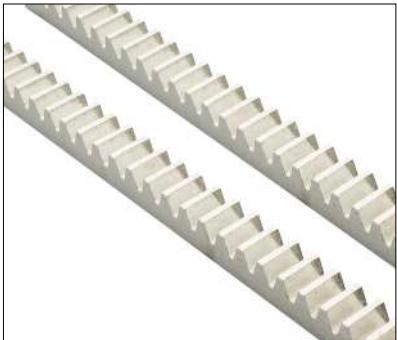
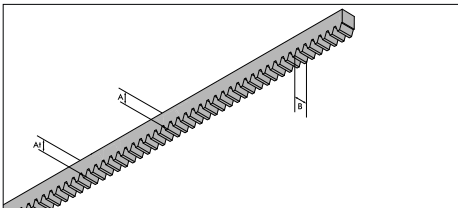

PALLET SIZE AND BULK

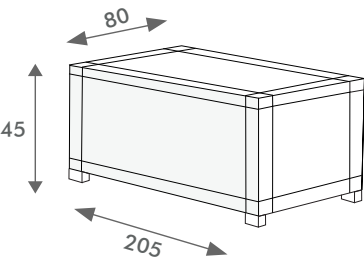

250 total pieces

ACRM6	
B Width:	30 mm
A Part height:	30 mm
Total height:	30 mm
Length:	1.000 mm
Weight:	5.980 g
Range:	4.000 Kg
Number of fit:	0



ACRM6-2000

M6 30X30X2000mm RACK
in galvanized steel, complete with accessories,
for gates with a maximum capacity of 4000 Kg.
Product to be welded. (3pcs.x m)

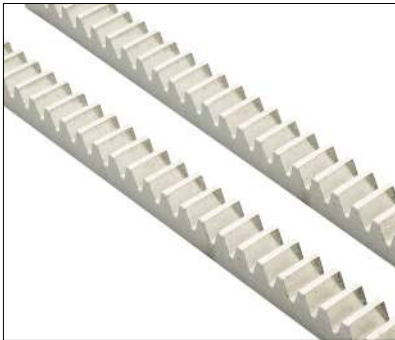
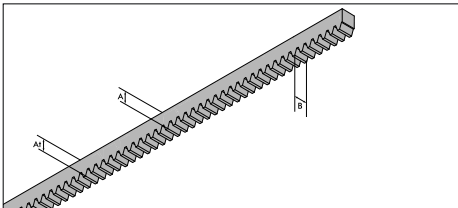

PALLET SIZE AND BULK

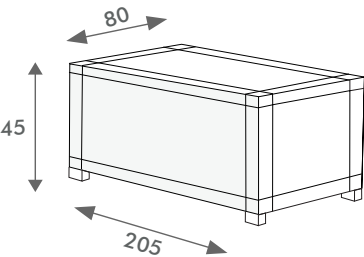

250 total pieces

ACRM6 - 2000	
B Width:	30 mm
A Part height:	30 mm
Total height:	30 mm
Length:	2.000 mm
Weight:	11.120 g
Range:	4.000 Kg
Number of fit:	0



WALL KEY SELECTOR



Code	Assembly	Material	Type of key	Number of contact points	IP	Weight	Size
ASM1S	Wall	Aluminum	EU cylinder	1	65	390 g	70 x 70 x 75 mm
ASM2		Aluminum	EU cylinder	2		406 g	
ASM2P		Aluminum	EU cylinder	2		406 g	
ASM2PC		Aluminum	EU cylinder	2		410 g	
ASM2P11		Aluminum	EU cylinder	2		420 g	

RECESSED KEY SELECTOR

Code	Assembly	Material	Type of key	Number of contact points	IP	Weight	Size
ASIP2	Wall recessed	Aluminum / Nylon	EU cylinder	2	65	386 g	70x70x75mm
ASIP2P		Aluminum / Nylon	EU cylinder	2		386 g	
ASIP2PC		Aluminum / Nylon	EU cylinder	2		390 g	
ASIP2P11		Aluminum / Nylon	EU cylinder	2		400 g	





LUX AUTOMATISMES
136 RUE DE BETTEMBOURG
L 5811 FENTANGE
www.lux-automatismes.lu
contact@lux-automatismes.lu